

Shady GROVE

MINOR MASTER PLAN AMENDMENT



July 8, 2021

Shady Grove Sector Plan Minor Master Plan Amendment

Sectional Map Amendment



Overview

Background

- Existing Plan Area: Approximately 2,000 acres
- Proposed SMA: Reclassify approximately 514 acres
- Most of the Plan area will be retained



Plan Area

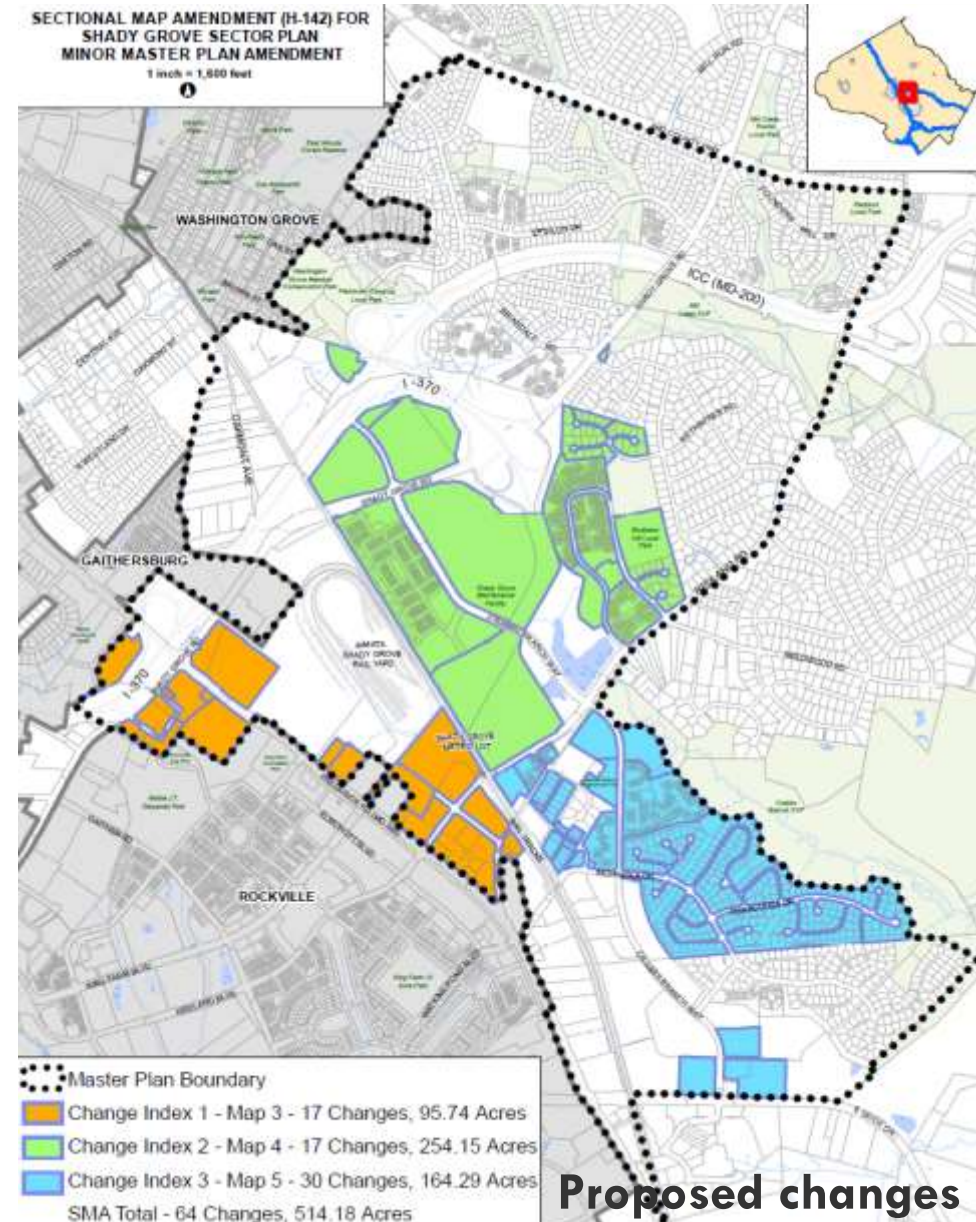

Change Areas

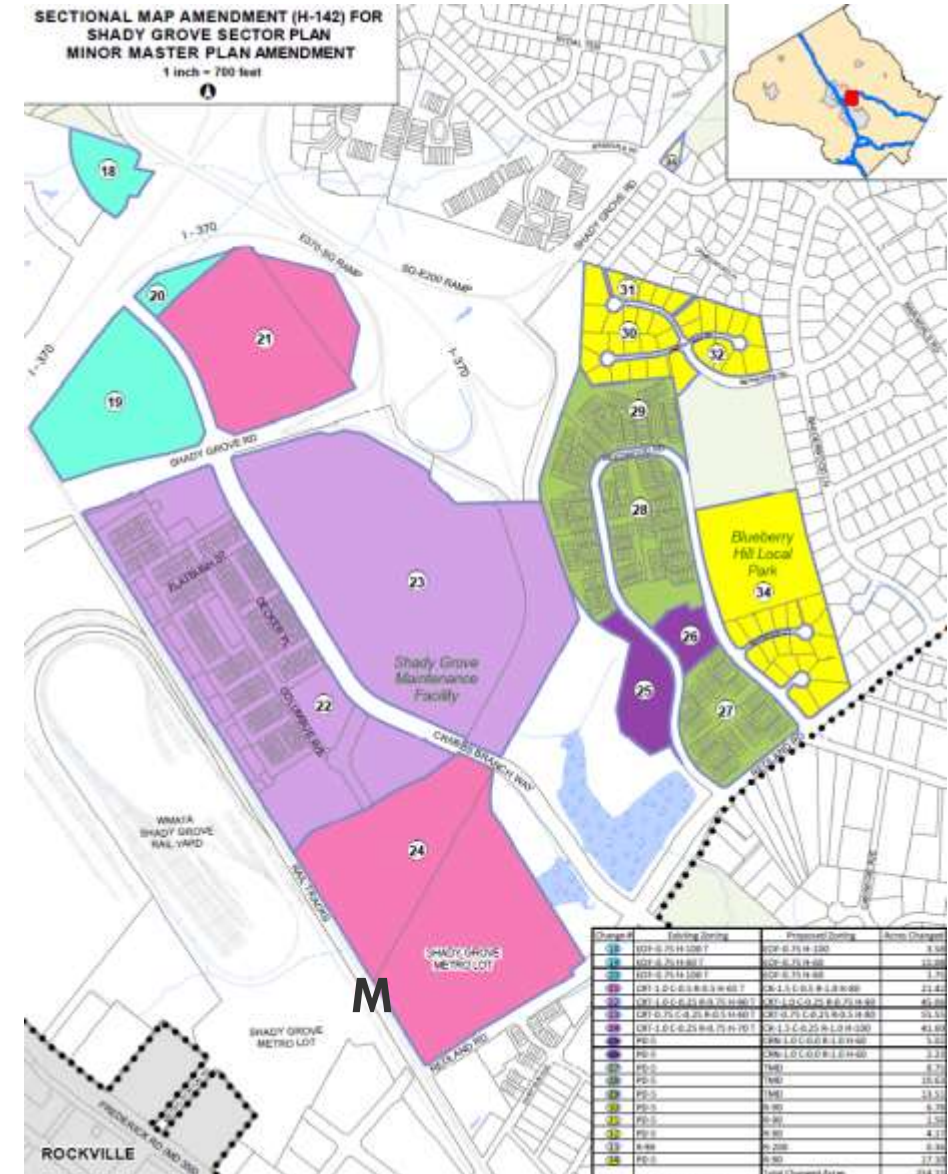
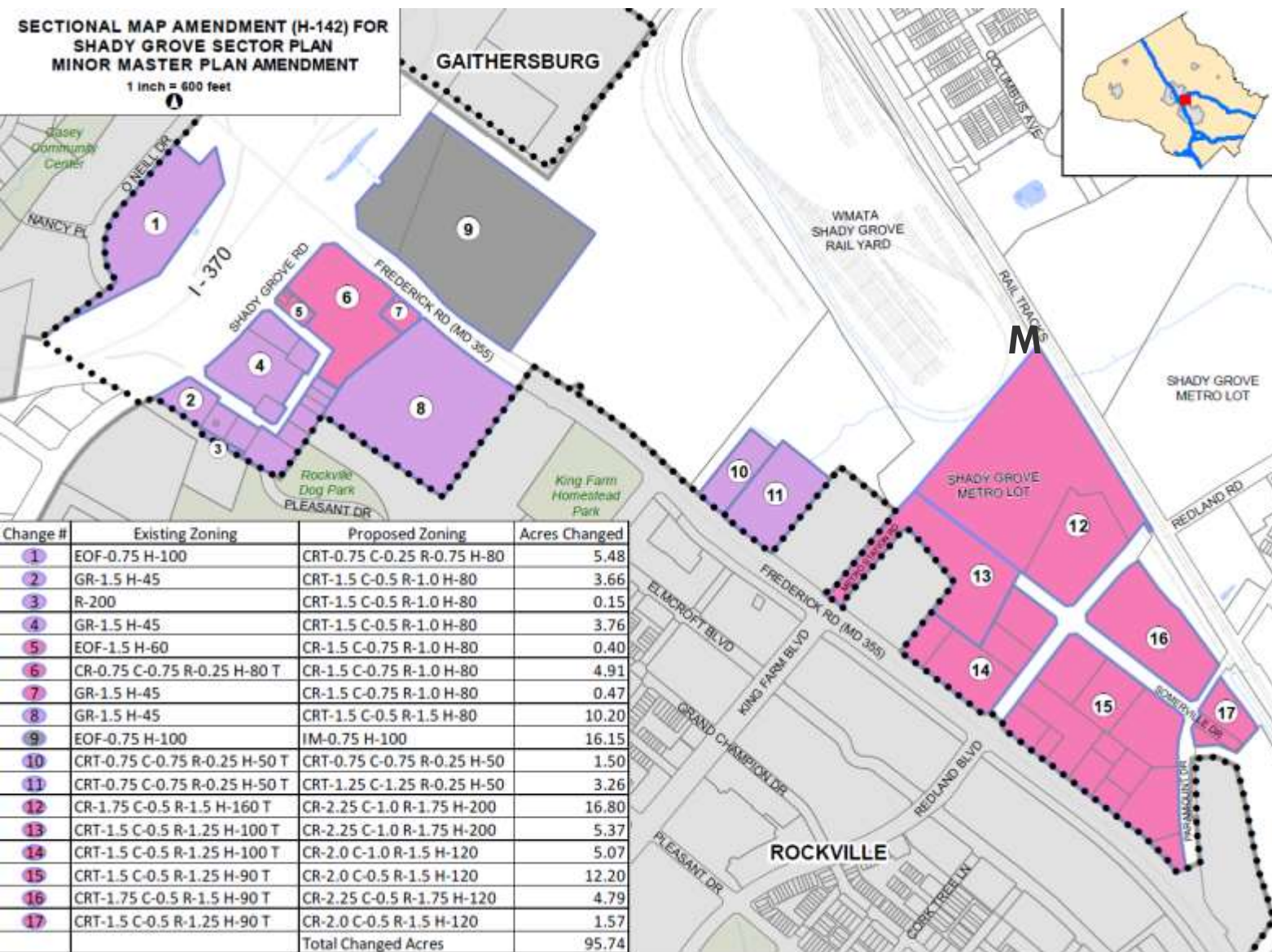

Change Areas

SECTIONAL MAP AMENDMENT (H-142) FOR SHADY GROVE SECTOR PLAN MINOR MASTER PLAN AMENDMENT
1 inch = 720 feet



SECTIONAL MAP AMENDMENT (H-142) FOR SHADY GROVE SECTOR PLAN MINOR MASTER PLAN AMENDMENT
1 inch = 720 feet

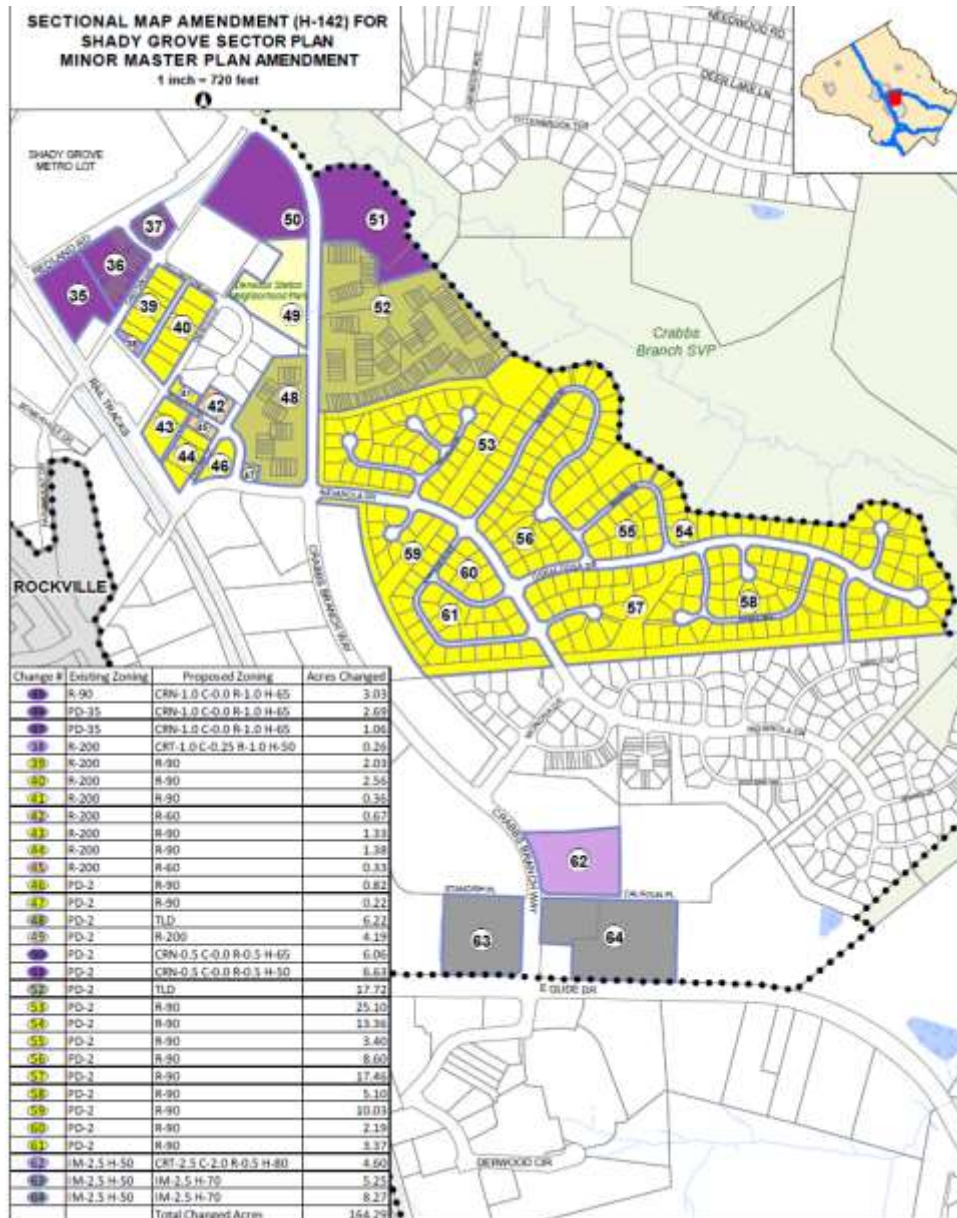

SMA Index

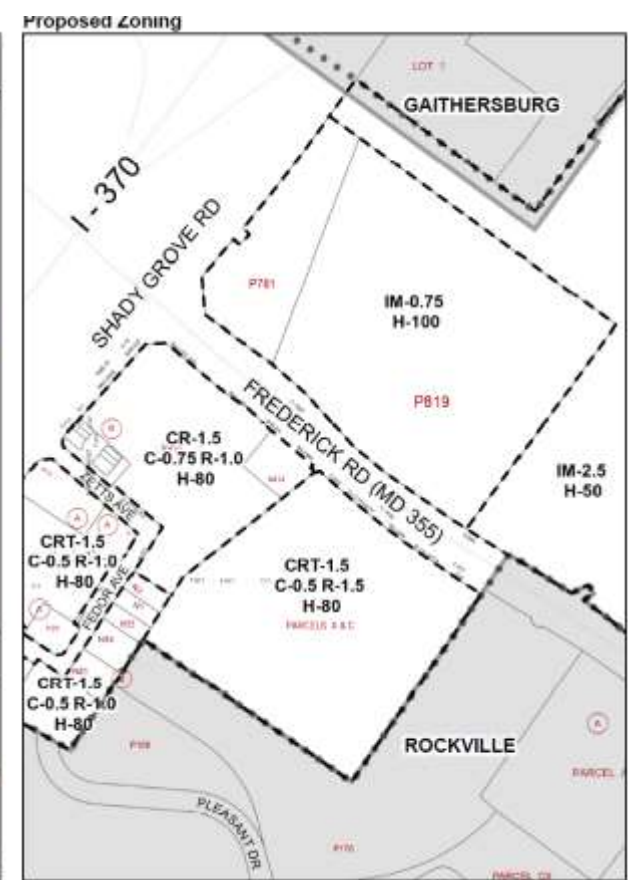
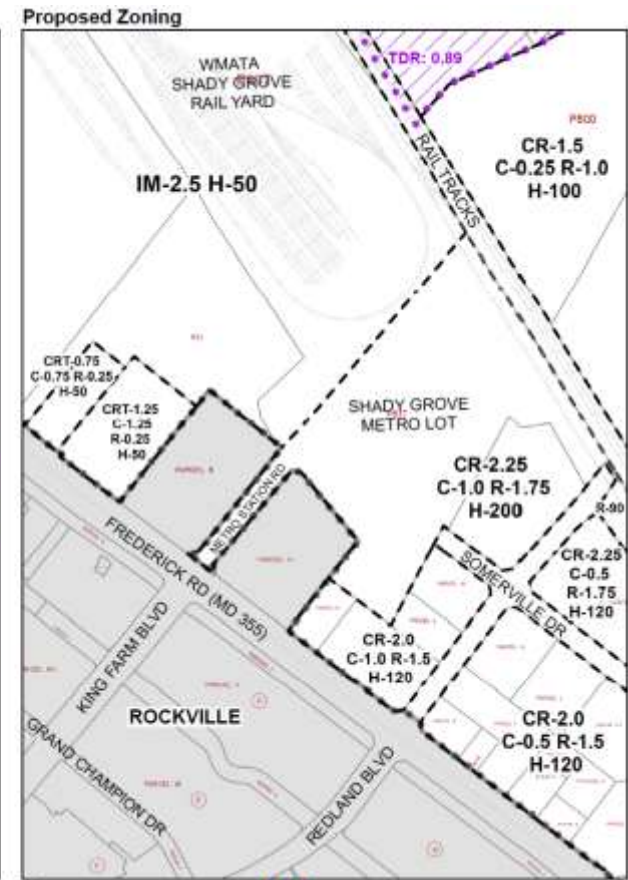
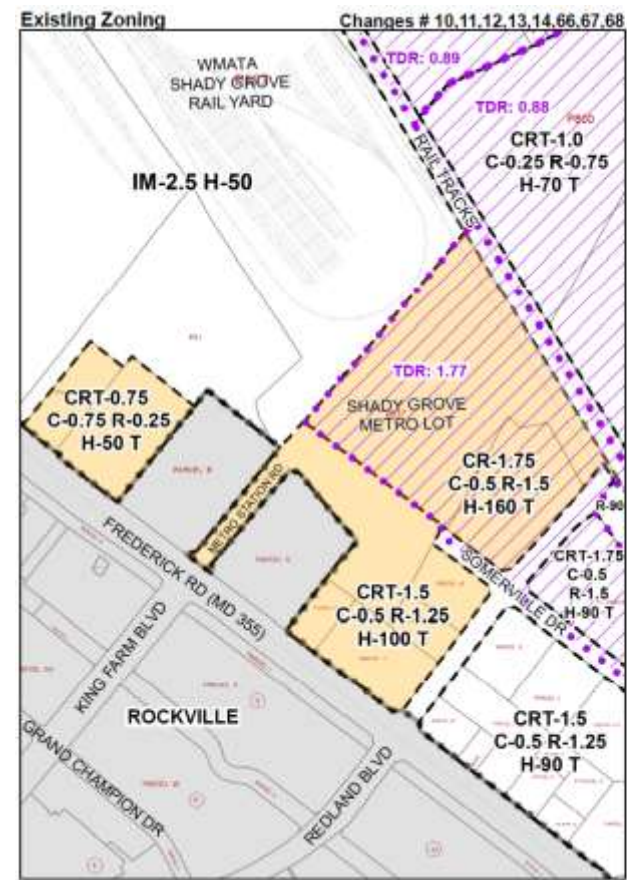

<https://mcatlas.org/sma/sgmmpa/>

Staff Recommendation

Staff recommends that the Planning Board approve the Request to File the Shady Grove Sector Plan Minor Master Plan Amendment to implement zoning recommendations in the approved and adopted Sector Plan.