

Land Use Plan

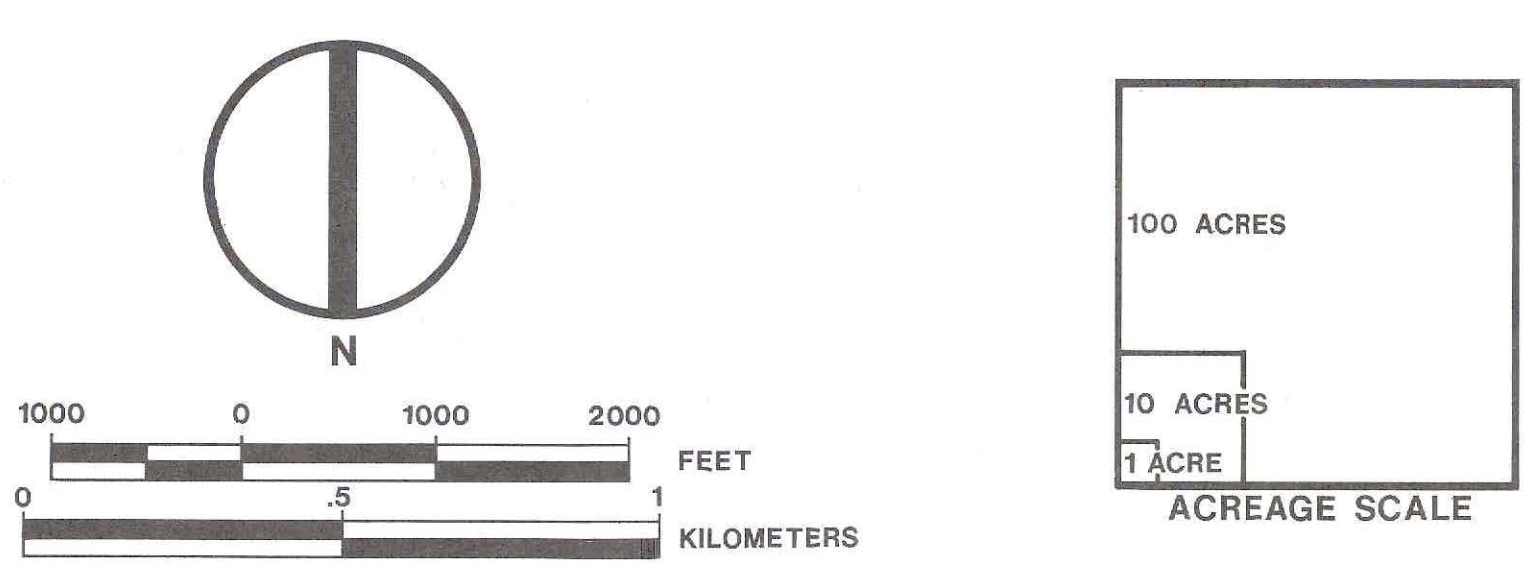

- Planning Area Boundary
- Municipality Boundary
- Shady Grove Sector Plan Area Boundary
- Properties in Other Planning Areas Affected by This Master Plan

GERMANTOWN & VICINITY
PLANNING AREA

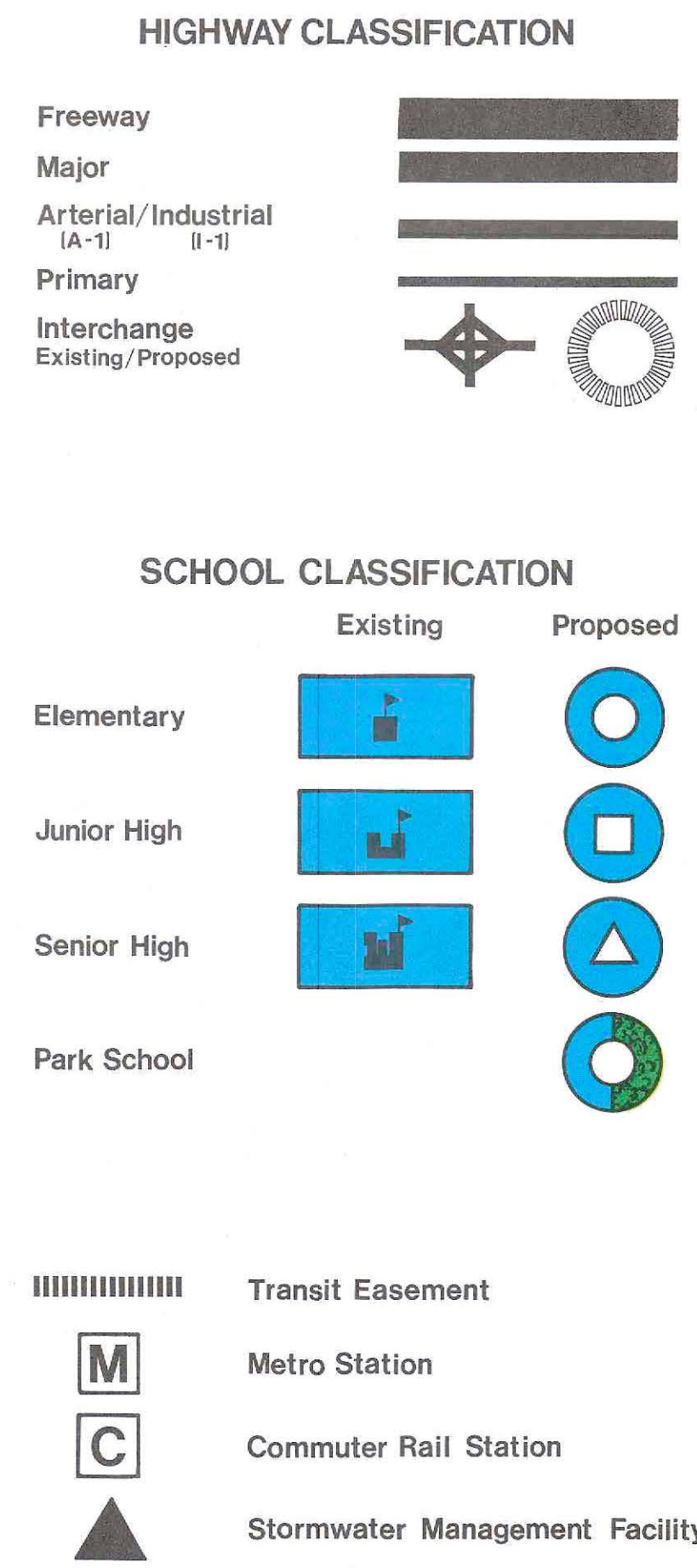
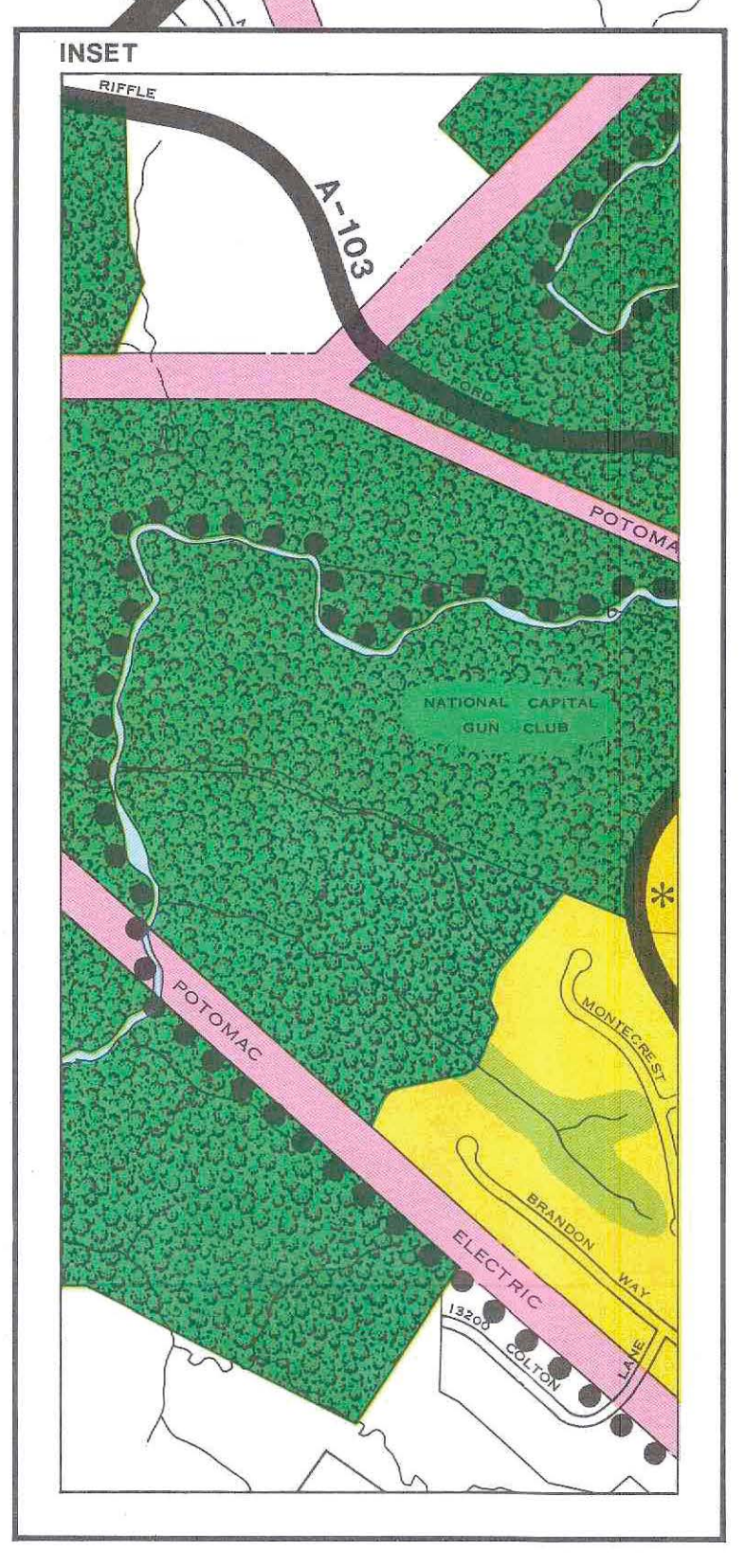

- NOTES:
- A future Master Plan Amendment will determine the ultimate land use pattern in this area. Alternatives which will be examined will include residential uses and/or moderate-intensity employment on all or part of the Thomas Farm. Particular consideration should be given to development consistent with and supporting the Life Sciences Center and related research activities.
 - A future Master Plan Amendment will examine the option of preserving this area as open space and encouraging continued farming of the land.
 - This Plan proposes a linear open space feature which should traverse the Shady Grove West Area. The character of this open space area will be determined by the land uses through which it passes.
 - The King Farm will be re-examined in the context of a future Master Plan Amendment. The possibility of providing a mix of residential and office uses will be explored.
 - The land use plans for the City of Gaithersburg, City of Rockville, Town of Washington Grove, Oakmont Special Study Area and Shady Grove Sector Plan Area are shown for information only. See these plans for details.

CERTIFICATION OF APPROVAL AND ADOPTION

The Gaithersburg Vicinity Master Plan, being an amendment to the 1971 Gaithersburg Vicinity Master Plan; a portion of the 1980 Potomac Subregion Master Plan as amended in 1982; a portion of the 1968 Rock Creek Master Plan, as amended; a portion of the 1977 Sector Plan for the Shady Grove Transit Station Area; the Master Plan of Blonery, 1978; the Master Plan for Historic Preservation, 1979, as amended; the General Plan for the Physical Development of the Maryland-Washington Regional District; and the Master Plan of Highways within Montgomery County, Maryland, has been approved by the Montgomery County Council, sitting as the District Council, by Resolution No. 10-1003 and has been adopted by The Maryland-National Capital Park and Planning Commission by Resolution 85-2 on January 9, 1985 after a duly advertised public hearing pursuant to Article 28 of the Annotated Code of Maryland, 1983 (1984 Supp.).

The Maryland-National Capital Park and Planning Commission

John Rhoads, Chairman
Norman L. Christeller, Vice Chairman
A. Edward Navarra, Secretary-Treasurer

THE MARYLAND-NATIONAL CAPITAL PARK AND PLANNING COMMISSION

Samuel Y. Batts, Roy L. Dobney, Jr., Mable Cressie, Judith B. Heiman,
Richmond M. Keeney, Burt Keller, Betty Ann Krahnik, Margaret Yewell