

DC • MD • VA

HOME & DESIGN

high on
style

**STUNNING
HOMES**
BY LOCAL
ARCHITECTS

SPA DAYS
LUXURY BATHS



DISPLAY UNTIL NOVEMBER 7, 2017
FALL 2017 \$5.95US



TIGER EYE



GRANITE - MARBLE - QUARTZ
QUARTZITE - SEMI PRECIOUS

GRAMACO

www.gramaco.com/tigereye
8730-C Greenwood Place Savage MD 20763

front+center

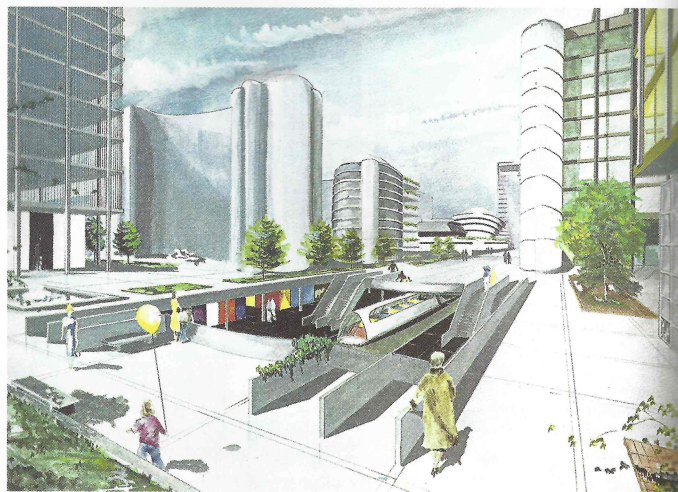

Above and below: Speculative sketches by D. Winklosky of a future Montgomery County, circa 1964. Courtesy of the Maryland-National Capital Park and Planning Commission.

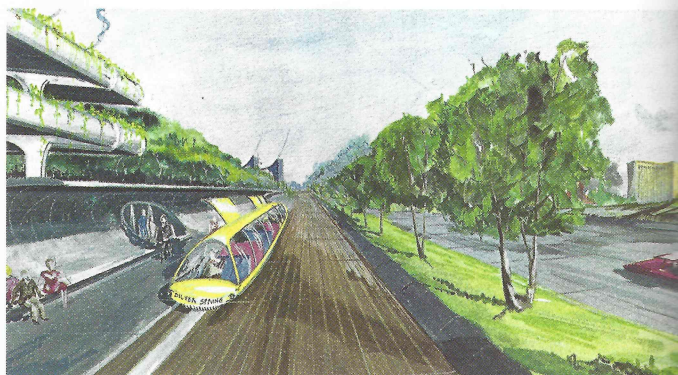

IN PRINT

Montgomery Modern

Mid-Century Modern fans might be surprised to learn that there are many examples of the vernacular in the DC area. In *Montgomery Modern: Modern Architecture in Montgomery County, Maryland, 1930-1979*, author and local architectural historian Clare Lise Kelly documents these enduring mid-century relics, from office towers and high rises to storefronts and tract homes, that reflect post-War optimism and materials of the Atomic Age. Published by the Montgomery County Planning Department, the 2015 book also chronicles the architects, landscape architects, planners and developers behind these designs.

On October 8, a Montgomery Modern bus tour will visit Potomac

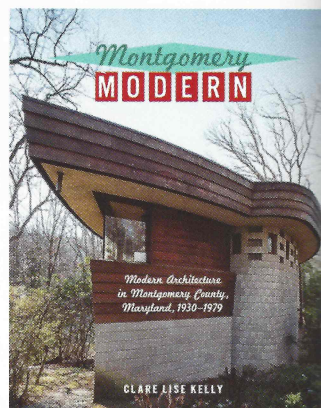

homes from this era, along with the mid-century Charles E. Smith campus in Rockville. And on October 16, the author will speak at George Washington University Museum. montgomeryplanning.org/planning/historic/montgomery-modern/ —S.J.D.