

**MONTGOMERY COUNTY HISTORIC PRESERVATION COMMISSION**  
**STAFF REPORT**

<b>Address:</b>	13630 Georgia Ave, Silver Spring, MD 20906	<b>Meeting Date:</b>	12/5/2018
<b>Resource:</b>	Master Plan Site #27/17 (Aspin Hill Pet Cemetery)	<b>Report Date:</b>	11/28/2018
<b>Applicant:</b>	Montgomery County Humane Society, Inc. (Brian Donnelly, Agent)	<b>Public Notice:</b>	11/21/2018
<b>Review:</b>	HAWP	<b>Tax Credit:</b>	No
<b>Case Number:</b>	27/17--18A	<b>Staff:</b>	Brian Crane

**PROPOSAL:** Retroactive Tree Removal, Additional Tree Removal, and Alterations to the Features of the Environmental Setting

---

**STAFF RECOMMENDATION:**

Staff recommends that the HPC **approve with three (3) conditions** the HAWP application.

1. The applicant shall prepare documentation that should include, at a minimum, a detailed map and inventory of character defining trees, plantings, gravestones, statuary, fences and other landscape features that contribute to the overall significance of the historic site and are an integral part of its environmental setting.
2. The applicant shall prepare a landscape maintenance plan that evaluates the health of trees and plantings within the cemetery, identifies invasive trees and vegetation, and provides recommendations for pruning, removal, and replanting as necessary to maintain the environmental setting and historical character of the cemetery. This plan must be reviewed by Staff prior to any further tree removal or landscaping as mentioned in the application. Staff recommends that the inventory and maintenance plan be developed by a landscape architect.
3. The applicant shall use the least disruptive technique for any future tree removal in order to avoid inappropriate changes to the environmental setting. Use the smallest machinery that can accomplish the task safely. Avoid moving stones unless necessary. Where it is unavoidable, care must be used to move stones without damaging them. The original location should be clearly marked so that it can be returned to its original place and orientation. Spraying herbicides should be avoided as these can damage gravestones.

**ARCHITECTURAL DESCRIPTION**

**SIGNIFICANCE:** Master Plan Site designated in 1991  
**STYLE:** Tudor Revival (main house on site); landscape style is unspecified in the nomination  
**DATE:** 1921

**Excerpt from *Places from the Past*:**

The Aspin Hill Pet Cemetery is one of the largest and earliest pet cemeteries in the country. Richard and Bertha Birney, breeders of Boston terriers, Scotties, and schnauzers, established a boarding kennel here in 1921. The business included care of health care facilities, described in the 1930s as “the only authorized animal hospital south of New York”; and a four-acre pet cemetery. Cemetery records, dating back to 1922, document more than 50,000 animal burials. Notable pets buried in the cemetery include seven dogs that belonged to J. Edgar Hoover; Jiggs, from the Our Gang movie series; and Rags, mascot of the First Division in World War I “who risked life and limb in the Meuse-Argonne when he crossed enemy lines to deliver a note to Allied Forces.” President Lyndon Johnson’s dogs were cremated at Aspin Hill and the remains sent to Texas. The site includes a wide variety of gravestones, animal sculptures, and mature landscaping. Also on site are a frame chapel, a gable-roof kennel with decorative brickwork, and a 1930s brick bungalow. The Birneys named their residence and business after a similar kennel in England named Aspin Hill (in contrast to the local neighborhood of Aspen Hill).



Location of Aspin Hill Pet Cemetery, Outlined in Red.

**BACKGROUND:**

The subject tree removal and site alterations took place in late August 2018.

**PROPOSAL:**

The applicants propose the following work items to be approved retroactively:

- Remove fallen logs and branches from the ground throughout the cemetery;
- Trim dead branches from several trees; and
- Cut down and remove 3 dead or damaged trees.

The applicants propose the following future work items to be approved

- Trim dead branches from several trees; and
- Cut down and remove one dead and decaying tree; and
- Cut down and remove trees of less than 6” dmh.

### **APPLICABLE GUIDELINES**

In accordance with section 1.5 of the Historic Preservation Commission Rules, Guidelines, and Procedures (Regulation No. 27-97) (“Regulations”), in developing its decision when reviewing a Historic Area Work Permit application for an undertaking at a Master Plan site the Commission uses section 24A-8 of the Montgomery County Code (“Chapter 24A”), the *Secretary of the Interior’s Standards and Guidelines for Rehabilitation* (“Standards”), and pertinent guidance in applicable master plans. [Note: where guidance in an applicable master plan is inconsistent with the Standards, the master plan guidance shall take precedence (section 1.5(b) of the Regulations).] The pertinent information in these documents, incorporated in their entirety by reference herein, is outline below.

#### ***Sec. 24A-8. Same-Criteria for issuance.***

(a) The commission shall instruct the director to deny a permit if it finds, based on the evidence and information presented to or before the commission that the alteration for which the permit is sought would be inappropriate, inconsistent with or detrimental to the preservation, enhancement or ultimate protection of the historic site or historic resource within an historic district, and to the purposes of this chapter.

(b) The commission shall instruct the director to issue a permit, or issue a permit subject to such conditions as are found to be necessary to insure conformity with the purposes and requirements of this chapter, if it finds that:

- (1) The proposal will not substantially alter the exterior features of an historic site or historic resource within an historic district; or
- (2) The proposal is compatible in character and nature with the historical, archeological, architectural or cultural features of the historic site or the historic district in which an historic resource is located and would not be detrimental thereto or to the achievement of the purposes of this chapter; or
- (3) The proposal would enhance or aid in the protection, preservation and public or private utilization of the historic site or historic resource located within an historic district in a manner compatible with the historical, archeological, architectural or cultural value of the historic site or historic district in which an historic resource is located; or
- (4) The proposal is necessary in order that unsafe conditions or health hazards be remedied; or
- (5) The proposal is necessary in order that the owner of the subject property not be deprived of reasonable use of the property or suffer undue hardship; [emphasis added] or

(6) In balancing the interests of the public in preserving the historic site or historic resource located within an historic district, with the interests of the public from the use and benefit of the alternative proposal, the general public welfare is better served by granting the permit.

(c) It is not the intent of this chapter to limit new construction, alteration or repairs to any 1 period or architectural style.

(d) In the case of an application for work on an historic resource located within an historic district, the commission shall be lenient in its judgment of plans for structures of little historical or design significance or for plans involving new construction, unless such plans would seriously impair the historic or architectural value of surrounding historic resources or would impair the character of the historic district. (*Ord. No. 9-4, § 1; Ord. No. 11-59.*)

### ***Secretary of Interior's Standards for Rehabilitation***

The Secretary of the Interior defines rehabilitation as “the act or process of making possible a compatible use for a property through repair, alterations, and additions while preserving those portions or features, which convey its historical, cultural, or architectural values.” Because the property is a Master Plan Site, the Commission’s focus in reviewing the proposal should be the *Secretary of the Interior’s Standards for Rehabilitation*. The *Standards* are as follows:

2. The historic character of a property shall be retained and preserved. The removal of historic materials or alteration of features and spaces that characterize a property shall be avoided.
9. New additions, exterior alterations, or related new construction shall not destroy historic materials that characterize the property. The new work shall be differentiated from the old and shall be compatible with the massing, size, scale, and architectural features to protect the historic integrity of the property and its environment.
10. New additions and adjacent or related new construction shall be undertaken in such a manner that if removed in the future, the essential form and integrity of the historic property and its environment would be unimpaired.

### **STAFF DISCUSSION**

The applicant maintains that the trees were removed because of poor health and potential hazardous conditions. In the application, the owner acknowledges that the property is

in disrepair and overgrown with small invasive trees along the property perimeter and to a lesser degree within the Pet Cemetery. The Owner intends to restore and rehabilitate the overall property by removing trees that have been damaged by storms, in poor condition or declining health, and remove smaller trees (less than 6”) as funding and resources become available to recreate the park like setting. The Owner requests permission to remove poor, dead, damaged and invasive trees that may create a hazard to users and selectively under 6” dbh.

Sheet 1 of the site plans prepared by the applicant indicate 3 discrete areas within the cemetery where work was performed, including before and after photographs of the removal of dead branches and 3 trees. Sheet 2 indicates areas where the applicant would like to remove additional dead or damaged trees, and trees under 6” dbh. In addition to the three structures on site, the plans indicate the location of

“significant” and “specimen” trees. Areas of other, smaller trees are indicated by general outline of “tree canopy.” The location of individual grave stones, statuary, fencing and other contributing landscape elements of the cemetery are not noted. Staff understand that some gravestones were temporarily moved during work to protect them from damage, and then returned to their original locations.

Although no arborists report appears to have been prepared prior to tree removal, the landscaping company representative who performed the work states that the trees removed were “obviously dead and decaying in place.” While clear “before” photographs do not appear to be available for one of the trees removed, those provided for two of the trees appear to support this assertion. One tree had snapped during a storm and had already fallen. One of those proposed for removal, Tag #12, is shown on the plan as a specimen tree, but is clearly dead and decaying in place. There are a number of places in the cemetery where small volunteer saplings (less than 6” dbh) have sprouted immediately adjacent to gravestones. If left to grow, these will eventually displace the markers around them, undermining the site’s integrity.

Removal of dead or dying trees is compatible with the character and nature of the historical and cultural features of the site; aids in its protection and preservation; and is necessary to remedy potentially unsafe situations. The principle concern is that the work was undertaken without a tree inventory that assesses the health and condition of trees in the cemetery and that discusses their relationship to the overall site history and landscape. This makes it difficult to determine whether removal was strictly warranted in all cases, and whether the site’s environmental setting suffered a loss of integrity as a result.

Likewise, the work suffered from the lack of a map inventory of gravestones, statuary, fences and other significant landscape elements. While it may have been prudent to temporarily move some gravestones to prevent their damage in some cases, the absence of a map makes it impossible to determine whether items were returned to their correct locations. In general, moving stones should be avoided if possible, and tree work should use the smallest machinery that can accomplish the task safely. Where temporarily moving stones is unavoidable, care must be exercised to avoid damaging them. The original location should be clearly marked so that stones can be returned to their original place and orientation.

#### **STAFF RECOMMENDATION:**

Staff recommends that the Commission **approve with conditions** the HAWP application under the Criteria for Issuance in Chapter 24A-8(b), having found that the proposal is compatible with the character and nature of the historical and cultural features of the site; aids in its protection and preservation; is necessary to remedy potentially unsafe situations; and is compatible in character with the resource and the purposes of Chapter 24A;

and with the *Secretary of the Interior’s Standards for Rehabilitation*;

and with the general conditions that the applicant:

1. Prepare documentation that will include, at a minimum, a detailed map and inventory of character defining trees, plantings, gravestones, statuary, fences and other landscape features that contribute to the overall significance of the historic site and are an integral part of its environmental setting;
2. Prepare a landscape maintenance plan that evaluates the health of trees and plantings within the cemetery, identifies invasive trees and vegetation, and provides recommendations for pruning, removal, replanting and other maintenance as necessary to maintain the environmental setting and historical character of the cemetery. This plan must be reviewed by Staff prior to any further tree removal or landscaping as mentioned in the application. Staff recommends that the inventory

and maintenance plan be developed by a landscape architect; and,

3. Prepare to use the least disruptive technique for any future tree removal in order to avoid inappropriate changes to the environmental setting. Use the smallest machinery that can accomplish the task safely. Avoid moving stones unless necessary. Where it is unavoidable, care must be used to move stones without damaging them. The original location should be clearly marked so that it can be returned to its original place and orientation. Spraying herbicides should be avoided as these can damage gravestones.

858017



DPS-06

HISTORIC PRESERVATION COMMISSION  
301/563-3400

APPLICATION FOR  
HISTORIC AREA WORK PERMIT

Contact Email: bdonnely@mhgpa.com Contact Person: Brian Donnelly  
Daytime Phone No.: 301-670-0840  
Tax Account No.: 00951987  
Name of Property Owner: Mont. Co. Humane Society Inc Daytime Phone No.: 240-252-2555  
Address: 601 S. Stone Street Ave., Rockville MD 20850  
Street Number City State Zip Code  
Contractor: \_\_\_\_\_ Phone No.: \_\_\_\_\_  
Contractor Registration No.: \_\_\_\_\_  
Agent for Owner: Cris Bombaugh Daytime Phone No.: 240-252-2555

LOCATION OF BUILDING/PREMISE

House Number: 13730 Street: Georgia Ave  
Town/City: Silver Spring Nearest Cross Street: Aspen Hill Road  
Lot: \_\_\_\_\_ Block: \_\_\_\_\_ Subdivision: \_\_\_\_\_  
Liber: 34247 Folio: 00703 Parcel: 719

PART ONE: TYPE OF PERMIT ACTION AND USE

- 1A. CHECK ALL APPLICABLE
- |                                    |                                  |  |  |                                    |  |  |                               |                               |
|------------------------------------|----------------------------------|--|--|------------------------------------|--|--|-------------------------------|-------------------------------|
| <input type="checkbox"/> Construct | <input type="checkbox"/> Extend  | <input checked="" type="checkbox"/> Alter/Revise | <input type="checkbox"/> AC                              | <input type="checkbox"/> Stab      | <input type="checkbox"/> Room Addition                             | <input type="checkbox"/> Porch         | <input type="checkbox"/> Deck | <input type="checkbox"/> Shed |
| <input type="checkbox"/> Move      | <input type="checkbox"/> Install | <input type="checkbox"/> Wreck/Raze              | <input type="checkbox"/> Solar                           | <input type="checkbox"/> Fireplace | <input type="checkbox"/> Woodburning Stove                         | <input type="checkbox"/> Single Family |                               |                               |
| <input type="checkbox"/> Revision  | <input type="checkbox"/> Repair  | <input type="checkbox"/> Revocable               | <input type="checkbox"/> Fence/Wall (complete Section 4) |                                    | <input checked="" type="checkbox"/> Other: <u>Ex. Tree Removal</u> |  |                               |                               |

1B. Construction cost estimate: \$ \_\_\_\_\_  
1C. If this is a revision of a previously approved active permit, see Permit # \_\_\_\_\_

PART TWO: COMPLETE FOR NEW CONSTRUCTION AND EXTEND/ADDITIONS

2A. Type of sewage disposal: 01  WSSC 02  Septic 03  Other: \_\_\_\_\_  
2B. Type of water supply: 01  WSSC 02  Well 03  Other: \_\_\_\_\_

NA

PART THREE: COMPLETE ONLY FOR FENCE/RETAINING WALL

NA

3A. Height \_\_\_\_\_ feet \_\_\_\_\_ inches  
3B. Indicate whether the fence or retaining wall is to be constructed on one of the following locations:  
 On party line/property line  Entirely on land of owner  On public right of way/easement

I hereby certify that I have the authority to make the foregoing application, that the application is correct, and that the construction will comply with plans approved by all agencies listed and I hereby acknowledge and accept this to be a condition for the issuance of this permit.

Signature of person submitting plans: [Signature] Date: 10/24/2018

Approved: \_\_\_\_\_ For Chairperson, Historic Preservation Commission  
Disapproved: \_\_\_\_\_ Signature: \_\_\_\_\_ Date: \_\_\_\_\_  
Application/Permit No.: \_\_\_\_\_ Date Filed: \_\_\_\_\_ Date Issued: \_\_\_\_\_

**THE FOLLOWING ITEMS MUST BE COMPLETED AND THE  
REQUIRED DOCUMENTS MUST ACCOMPANY THIS APPLICATION.**

**1. WRITTEN DESCRIPTION OF PROJECT**

**a. Description of existing structure(s) and environmental setting, including their historical features and significance:**

The property is one of the largest Pet cemeteries in the US and contains a kennel (+/-1921) and caretakers house built in the early 1930's. The main house is in the Tudor Revival style architecture. The property also contains approximately five acres devoted to the Pet Cemetery. The Pet Cemetery is a large open lawn area with a number of mature trees providing a pastoral setting to the historic property.

**b. General description of project and its effect on the historic resource(s), the environmental setting, and, where applicable, the historic district:**

Due to funding and change in Ownership, the property has become in disrepair and overgrown with small invasive trees along the property perimeter and to a lesser degree within the Pet Cemetery. The Owner intends to restore and rehabilitate the overall property by removing trees that have been damaged by storms, in poor condition or declining health, and remove smaller trees (less than 6") as funding and resources become available to recreate the park like setting. The Owner requests permission to remove poor, dead, damaged and invasive trees that may create a hazard to users and selectively under 6" dbh.

**2. SITE PLAN**

Site and environmental setting, drawn to scale. You may use your plot. Your site plan must include:

- a. the scale, north arrow, and date;
- b. dimensions of all existing and proposed structures; and
- c. site features such as walkways, driveways, fences, ponds, streams, trash dumpsters, mechanical equipment, and landscaping.

**3. PLANS AND ELEVATIONS**

You must submit 2 copies of plans and elevations in a format no larger than 11" x 17". Plans on 8 1/2" x 11" paper are preferred.

- a. Schematic construction plans, with marked dimensions, indicating location, size and general type of walls, window and door openings, and other fixed features of both the existing resource(s) and the proposed work.
- b. Elevations (facades), with marked dimensions, clearly indicating proposed work in relation to existing construction and, when appropriate, context. All materials and fixtures proposed for the exterior must be noted on the elevations drawings. An existing and a proposed elevation drawing of each facade affected by the proposed work is required.

**4. MATERIALS SPECIFICATIONS**

General description of materials and manufactured items proposed for incorporation in the work of the project. This information may be included on your design drawings.

**5. PHOTOGRAPHS**

- a. Clearly labeled photographic prints of each facade of existing resource, including details of the affected portions. All labels should be placed on the front of photographs.
- b. Clearly label photographic prints of the resource as viewed from the public right-of-way and of the adjoining properties. All labels should be placed on the front of photographs.

**6. TREE SURVEY**

If you are proposing construction adjacent to or within the dripline of any tree 6" or larger in diameter (at approximately 4 feet above the ground), you must file an accurate tree survey identifying the size, location, and species of each tree of at least that dimension.

**7. ADDRESSES OF ADJACENT AND CONFRONTING PROPERTY OWNERS**

For ALL projects, provide an accurate list of adjacent and confronting property owners (not tenants), including names, addresses, and zip codes. This list should include the owners of all lots or parcels which adjoin the parcel in question, as well as the owner(s) of lot(s) or parcel(s) which lie directly across the street/highway from the parcel in question.

PLEASE PRINT (IN BLUE OR BLACK INK) OR TYPE THIS INFORMATION ON THE FOLLOWING PAGE.  
PLEASE STAY WITHIN THE BOUNDS OF THE TEMPLATE, AS THIS WILL BE PHOTOCOPIED DIRECTLY ONTO MAILING LABELS.



Existing Property Condition Photographs (duplicate as needed)



Detail: Severe trunk and internal tree decay. Tree split +/-3 feet from base. overgrown with invasive vines. Poor Condition.

Applicant: \_\_\_\_\_

*B*

Page: 3

Existing Property Condition Photographs (duplicate as needed)



Detail: Severe trunk and internal tree decay. Tree split +/-3 feet from base. overgrown with invasive vines. Poor Condition.

Applicant: \_\_\_\_\_

Existing Property Condition Photographs (duplicate as needed)



Detail: Severe trunk and internal tree decay

Applicant: \_\_\_\_\_

*BS*

Existing Property Condition Photographs (duplicate as needed)



Detail: Severe trunk and internal tree decay

Applicant: \_\_\_\_\_

**Existing Property Condition Photographs (duplicate as needed)**



Detail: Severe trunk and internal tree decay

Applicant: \_\_\_\_\_

*CS*

**Existing Property Condition Photographs (duplicate as needed)**



Detail: Severe trunk and internal tree decay

Applicant: \_\_\_\_\_

Existing Property Condition Photographs (duplicate as needed)

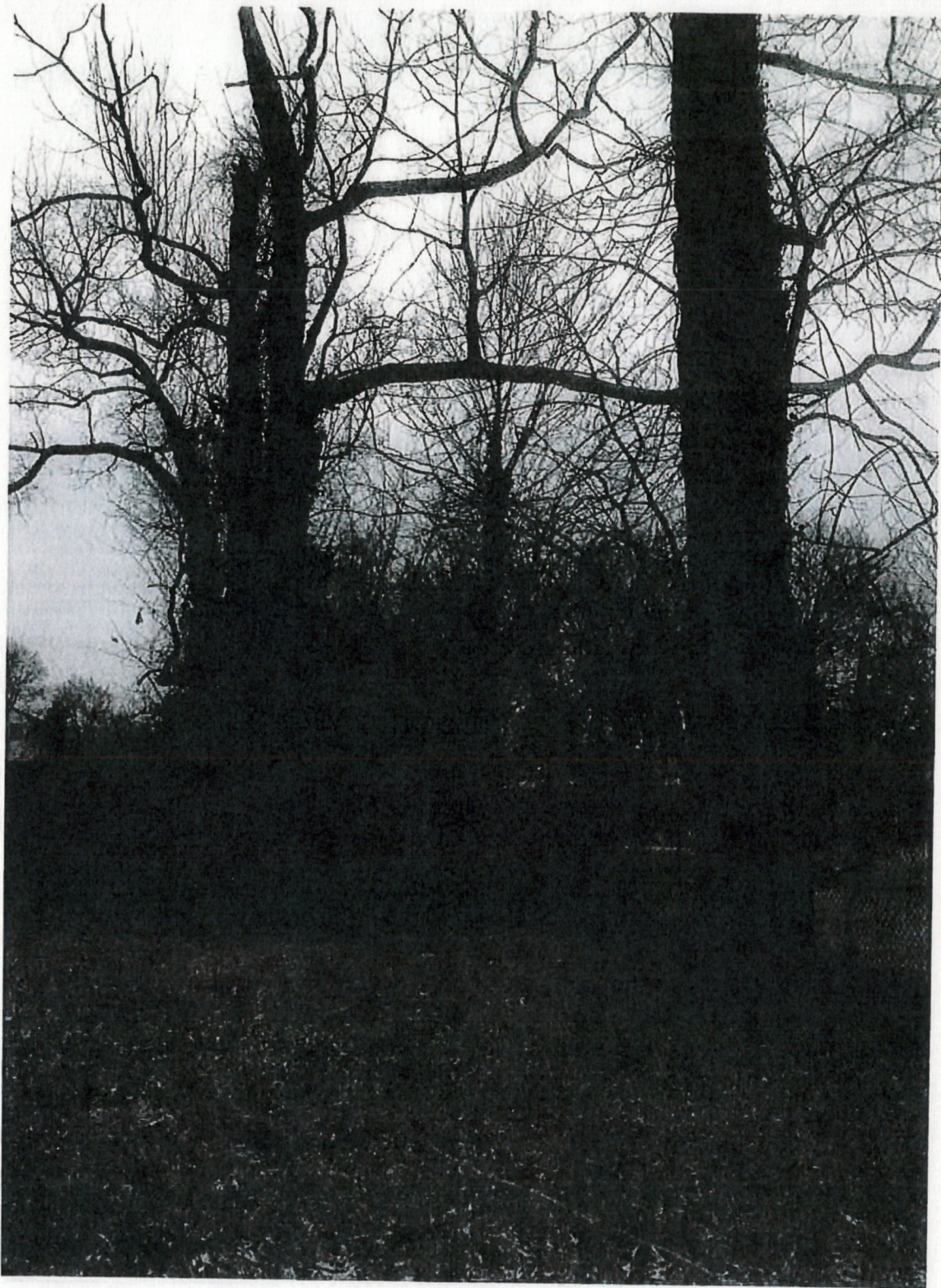

Detail: Crown damage, overgrown with invasive vines. .....  
Storm damage

Applicant: \_\_\_\_\_ *CB*

Existing Property Condition Photographs (duplicate as needed)



Detail: Crown damage, overgrown with invasive vines.  
Storm damage

Applicant: \_\_\_\_\_



Existing Property Condition Photographs (duplicate as needed)



Detail: Storm damage. Poor condition due to severe dieback  
Crown damage

Applicant: \_\_\_\_\_

*LB*

Existing Property Condition Photographs (duplicate as needed)

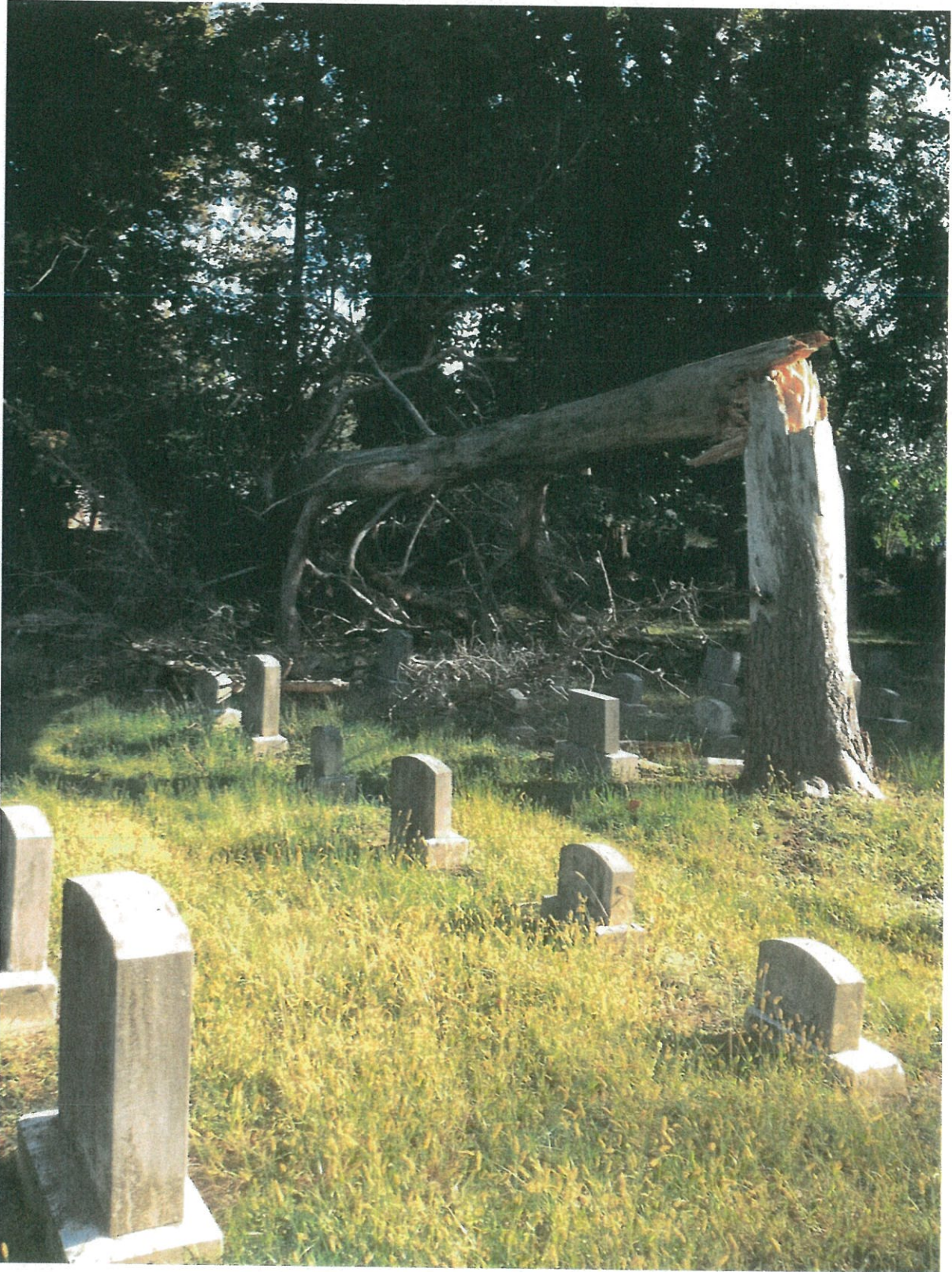

Detail: Storm damage. Poor condition due to severe dieback  
Crown damage

Applicant: \_\_\_\_\_

## **J. Hernandez Landscaping**

18325 Lost Knife Cir #102  
Montgomery Village, MD 20886-0306

October 29, 2018

Ms. Cris Bombaugh  
President & CEO  
Montgomery County Humane Society, Inc.  
601 S. Stonestreet Ave.  
Rockville, MD 20850

RE: Tree work

Dear Cris:

This summarizes the work my company performed at 13730 Georgia Ave. at the end of August, 2018.

We were asked to remove fallen logs and branches that were on the ground throughout the cemetery. We were also asked to trim some dead branches on several trees, and to take down a small number trees that were dead. In our estimation, the trees taken down were obviously dead and decaying in place, and were in potential danger of falling.

I hope this helps to clarify the work that was done.

Sincerely,

Jose Hernandez

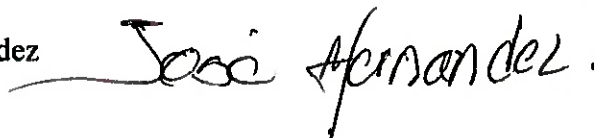
A handwritten signature in black ink that reads "Jose Hernandez". The signature is written in a cursive style with a long horizontal line extending to the left.

**ASPIN HILL PET CEMETERY - MONTGOMERY COUNTY HUMANE SOCIETY  
13730 GEORGIA AVENUE, SILVER SPRING**

Account	Name	Name2	Address1	City	State	Zip	Situs	Parcel	Lot / Block
<b>ADJOINING / CONFRONTING</b>									
13 00982454	Vestry of Wheaton Parish c/o Rev. Sarah Lammig	St. Mary Madealene Episcopal Church	3820 Aspen Hill Rd.	Wheaton	MD	20906	3820 Aspen Hill Rd.	P716/688	
13 01320746	Karen Wang et al		13607 Athania St.	Silver Spring	MD	20906	13607 Athania St.		
13 01321661	Johnnye Washington		3819 Wendy Ln	Silver Spring	MD	20906	3819 Wendy Ln		Lot 14 / 3
13 01319315	Giuseppe Basile		8811 Damascus Rd.	Damascus	MD	20872	3817 Wendy Ln		Lot 10 / 3
13 01321318	Sylvia Ellis et al		3815 Wendy Ln	Silver Spring	MD	20906	3815 Wendy Ln		Lot 9 / 3
13 01319554	Neil Bacchus et al		11311 Morning Gate Dr.	Rockville	MD	20852	3813 Wendy Ln		Lot 8 / 3
13 01320416	Hoan-Vu Tran-Ho	Thi Le Lam	3811 Wendy Ln	Silver Spring	MD	20906	3811 Wendy Ln		Lot 7 / 3
13 01320176	Richard & Toni Cain		3809 Wendy Ln	Silver Spring	MD	20906	3809 Wendy Ln		Lot 6 / 3
13 01321147	Isreal & M M Abarca		3807 Wendy Ln	Silver Spring	MD	20906	3807 Wendy Ln		Lot 5 / 3
13 01320267	Joaquin Fuentes et al		3805 Wendy Ln	Silver Spring	MD	20906	3805 Wendy Ln		Lot 4 / 3
13 01318958	Pimpa Khomsatyapongvut et al	c/o S Komsata yapongvudhi	3803 Wendy Ln	Silver Spring	MD	20906	3803 Wendy Ln		Lot 3 / 3
13 01321284	Jubita Centeno	Wililam Moreno	13608 Loyola St.	Silver Spring	MD	20906	13608 Loyola St.		Lot 2 / 3
13 01319918	Mateo & Dora Romero		13607 Loyola St.	Silver Spring	MD	20906	13607 Loyola St.		Lot 1 / 3
13 01321865	Andre Zida	Florence Zongo	3703 Wendy Ln.	Silver Spring	MD	20906	3703 Wendy Ln.		Lot 3 / 1

**ASPIN HILL PET CEMETERY - MONTGOMERY COUNTY HUMANE SOCIETY  
13730 GEORGIA AVENUE, SILVER SPRING**

Account	Name	Name2	Address1	City	State	Zip	Situs	Parcel	Lot / Block
13 01319372	Marco Ochoa		13700 Georgia Ave.	Silver Spring	MD	20906	13700 Georgia Ave.		Lot 2 / 1
13 00959595	Aspen Manor Shopping Center LLC		7200 Wisconsin Ave., Ste 1100	Bethesda	MD	20906	13621 Georgia Ave.	N674	Lot 1 / 1
13 03094106	Gate of Heaven Cemetery Inc.	Archdiocese of Washington	13801 Georgia Ave.	Silver Spring	MD	20906	13801 Georgia Ave.	N400	
13 00961383	13800 Georgia Ave. LLC		13800 Georgia Ave.	Silver Spring	MD	20906	13800 Georgia Ave.	N612	
13 03126511	L D G Inc.		8601 Georgia Ave. #200	Silver Spring	MD	20910	13830 Georgia Ave.	N528	

**ATTENDEES AT CITIZEN PRESUBMITTAL MEETING FOR PRELIMINARY PLAN HELD 9/25**

	Wilma C. Jones		4807 Camelot St.	Rockville	MD	20853			
	Tina Simmons	Dennis Green	6412 Forest Hill Ln.	Laurel	MD	20707			
	Glenn Wallace		9 Meadowcroft Ct.	Montgomery	MD	20886			
	Judy Fink		4102 Frankfort Dr.	Rockville	MD	20853			
	Jane Dean		3900 Isbell St.	Silver Spring	MD	20906			
	Abe Birch		8817 Goshen Mill Ct.	Gaithersburg	MD	20882			
	Rena Samuel		14317 Briarwood Terrace	Rockville	MD	20853			
	Joanna Nasios		4207 Aspen Hill Rd.	Rockville	MD	20853			
	Iftikhar Ahmad		13800 Georgia Ave.	Silver Spring	MD	20906			
	Phyllis Levine		4405 Kalmia St.	Rockville	MD	20853			
	Thomas Hardman		13921 Parkland Dr.	Rockville	MD	20853			
	Shirley Tao		13607 Athania St.	Silver Spring	MD	20906			

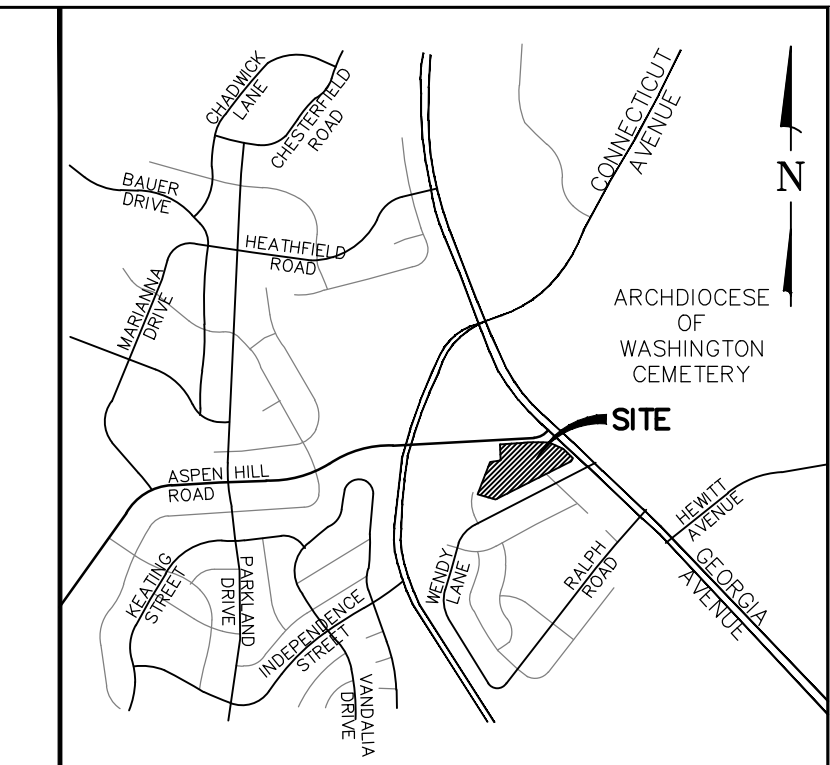

VICINITY MAP  
SCALE 1" = 2,000'

**LEGEND**

- SIGNIFICANT TREE
- SPECIMEN TREE
- TREE CANOPY
- SUBJECT SITE PROPERTY BOUNDARY
- OTHER PROPERTY BOUNDARY
- EX. WIRE FENCE
- CEMETERY LIMITS (APPROX)

**MHG**  
Civil Engineers  
Land Planners  
Landscape Architects  
Land Surveyors  
9220 Wightman Road, Suite 120  
Montgomery Village, MD 20886  
Phone: 301.670.0840  
www.mhgpa.com

Copyright © 2017 by Macris, Hendricks & Glascock, P.A. All Rights Reserved

OWNER  
Montgomery County Humane Society, Inc.  
601 S. Stonestreet Ave  
Rockville, MD 20850  
Attn: Crispin Bombaugh  
(240) 252-2555

NO.	DESCRIPTION	DATE

TAX MAP 218NW04 WSSC HR342

13TH ELECTION DISTRICT  
MONTGOMERY COUNTY  
MARYLAND

**PARCEL 719**  
**MONTGOMERY COUNTY**  
**HUMANE SOCIETY**  
**CAMPUS**

PROJ. MGR	BJD
DRAWN BY	FCJ
SCALE	1" = 50'
DATE	11.2.2018

**TREE REMOVAL EXHIBIT**

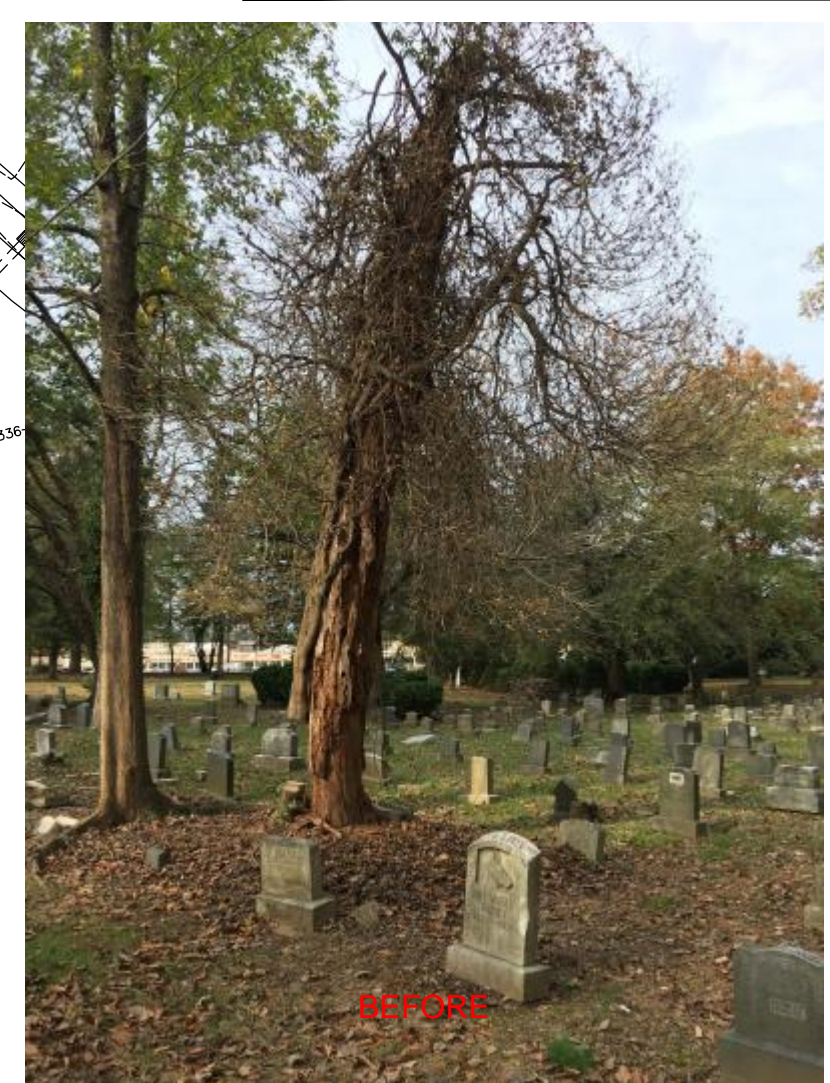
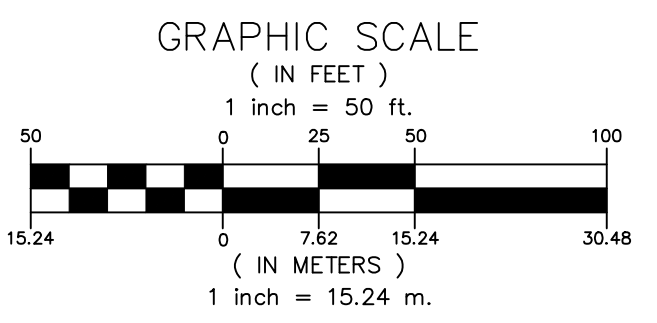

11/20/2018 11:02:08 AM 11/20/2018 3:36:44 PM Copyright © 2017 Macris, Hendricks & Glascock, P.A.

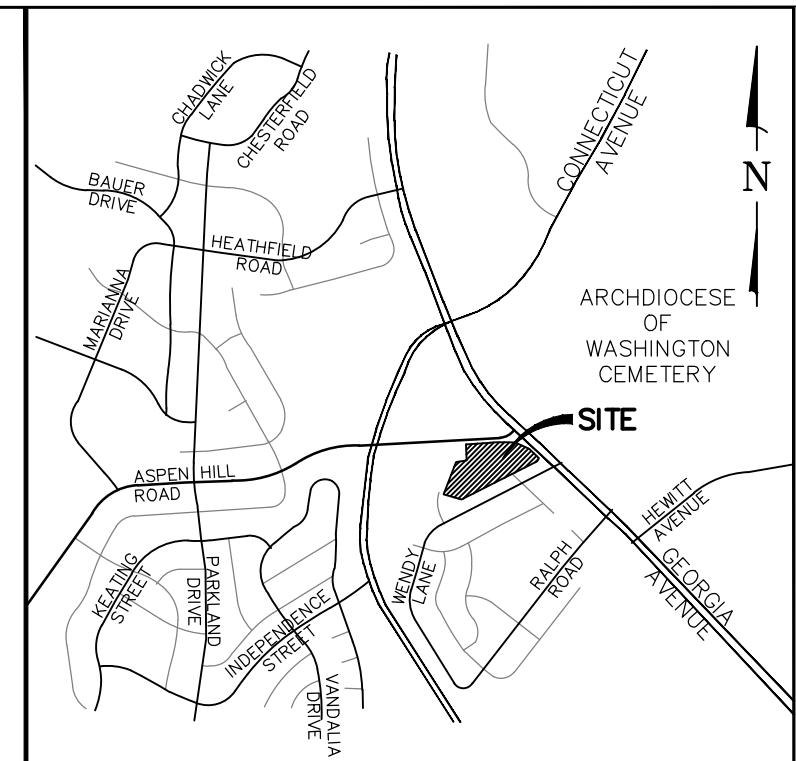

VICINITY MAP  
SCALE 1" = 2,000'



**LEGEND**

- SIGNIFICANT TREE
- SPECIMEN TREE
- TREE CANOPY
- SUBJECT SITE PROPERTY BOUNDARY
- OTHER PROPERTY BOUNDARY
- EX. WIRE FENCE
- CEMETERY LIMITS (APPROX)

OWNER  
Montgomery County Humane Society, Inc.  
601 S. Stonestreet Ave  
Rockville, MD 20850  
Attn: Crispin Bombaugh  
(240) 252-2555

REVISIONS

NO.	DESCRIPTION	DATE

TAX MAP 218NW04 WSSC HR342

13TH ELECTION DISTRICT  
MONTGOMERY COUNTY  
MARYLAND

**PARCEL 719  
MONTGOMERY COUNTY  
HUMANE SOCIETY  
CAMPUS**

PROJ. MGR	BJD
DRAWN BY	FCJ
SCALE	1" = 50'
DATE	11.2.2018

**TREE REMOVAL EXHIBIT**

