

CORDELL AVE.

WISCONSIN AVE.

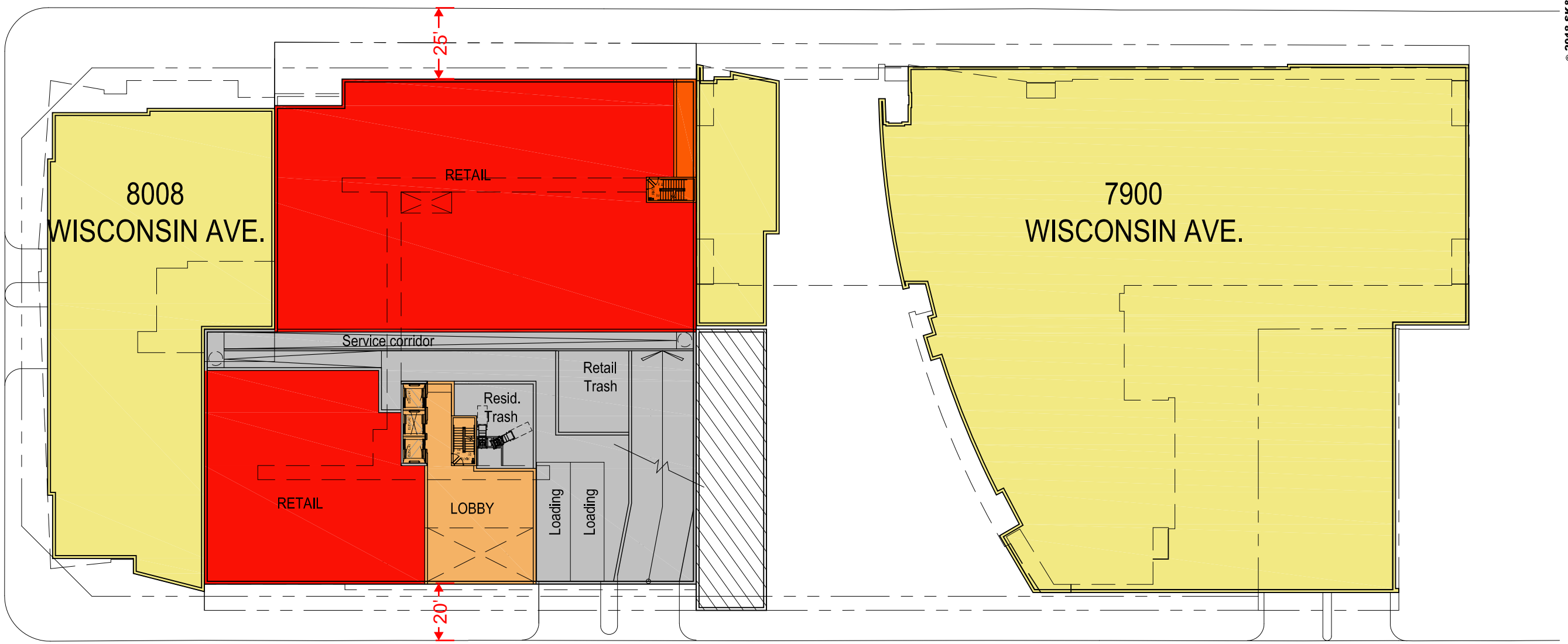

WOODMONT AVE.

8000 Wisconsin Ave.
Bethesda, MD

Scale: NTS
Date: 2018-03-12

WISCONSIN AVE.

CORDELL AVE.

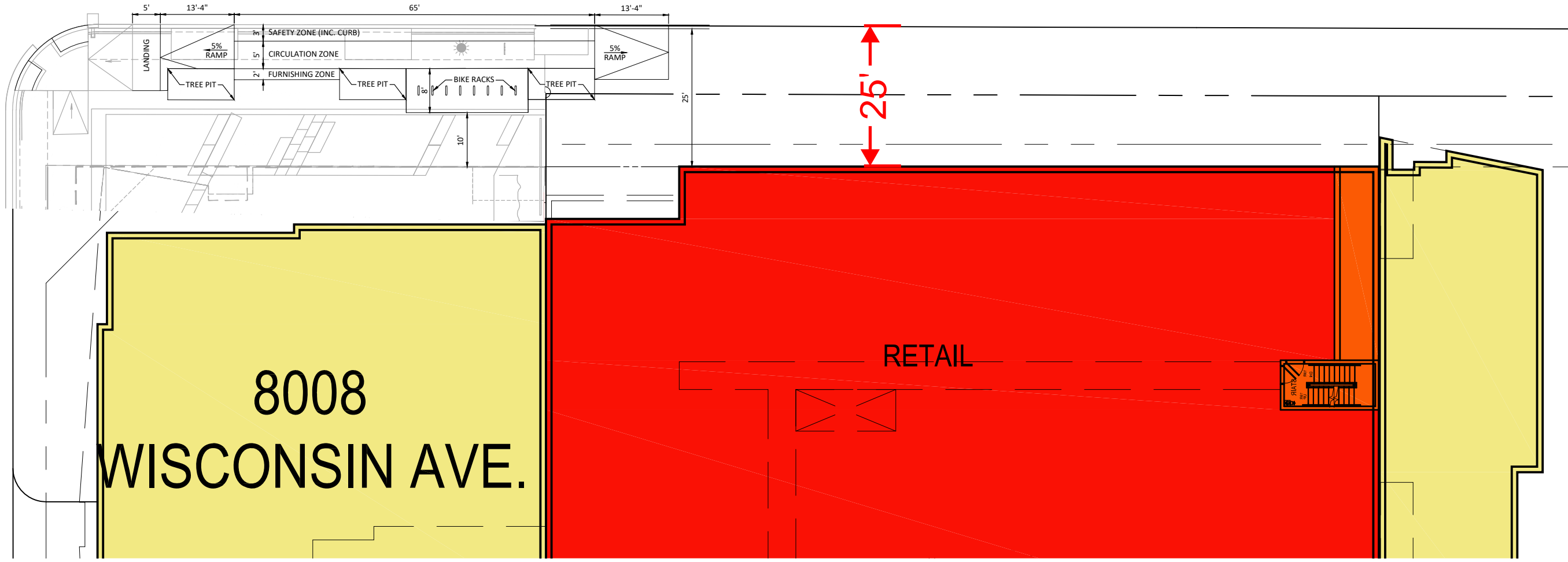

Future Existing Conditions



8000 Wisconsin Ave.
Bethesda, MD

Scale: NTS
Date: 2018-03-12

Future Existing Conditions

7900 Wisconsin

6' Setback

Allowed 25% Glass

Blank party-wall

PL

8000 Wisconsin Ave.
Bethesda, MD

Scale: NTS
Date: 2018-03-12





Blank party-wall

8008 Wisconsin

PL

PL

8000 Wisconsin Ave.
Bethesda, MD

Future Existing Conditions

- Skyline / Crown
- Massing Line
- Vertical Element
- Massing Plane
- Retail Plane



missing tooth

7900 Wisconsin

8000 Wisconsin

8008 Wisconsin

8000 Wisconsin Ave.
Bethesda, MD

Design Process

- Skyline / Crown
- Massing Line
- Vertical Element
- Massing Plane
- Retail Plane

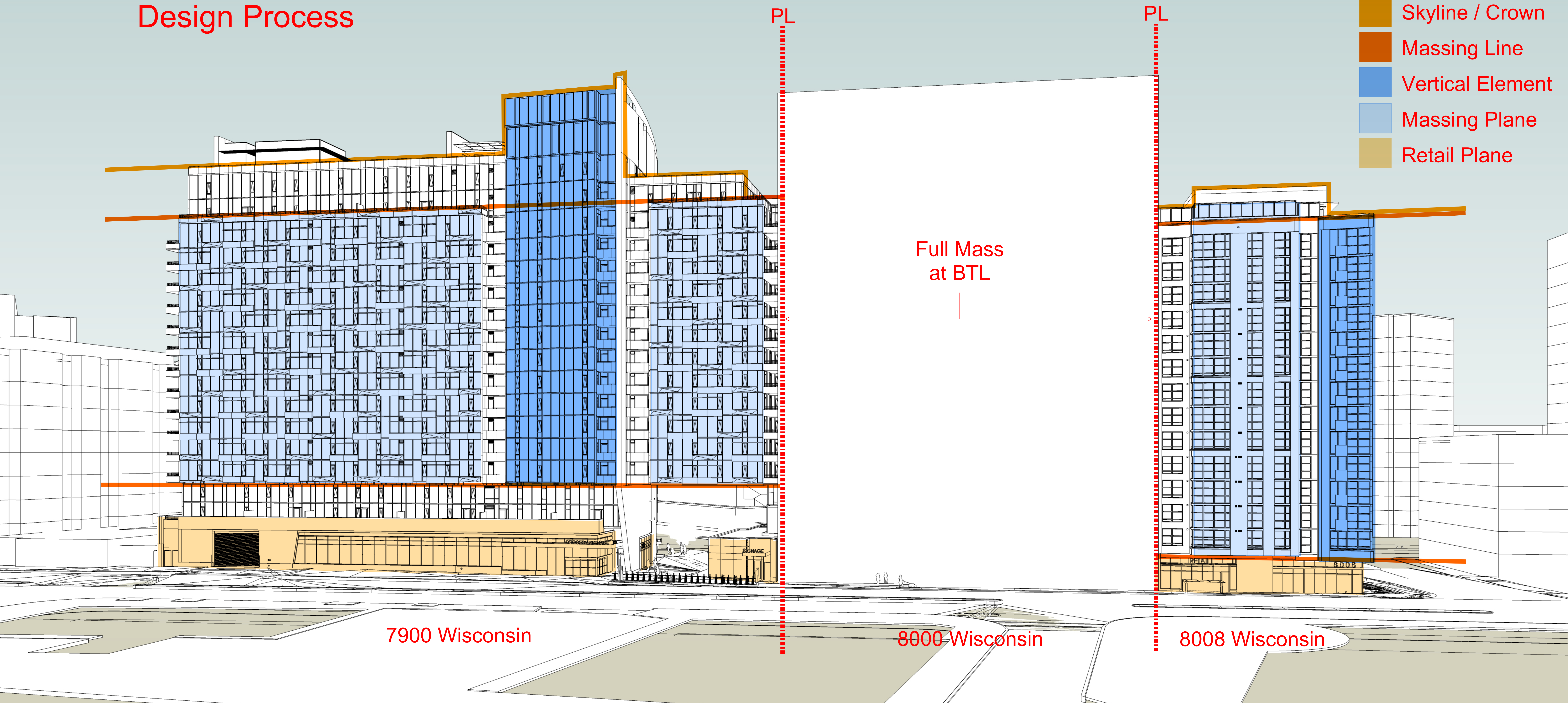

Design Process

- Skyline / Crown
- Massing Line
- Vertical Element
- Massing Plane
- Retail Plane

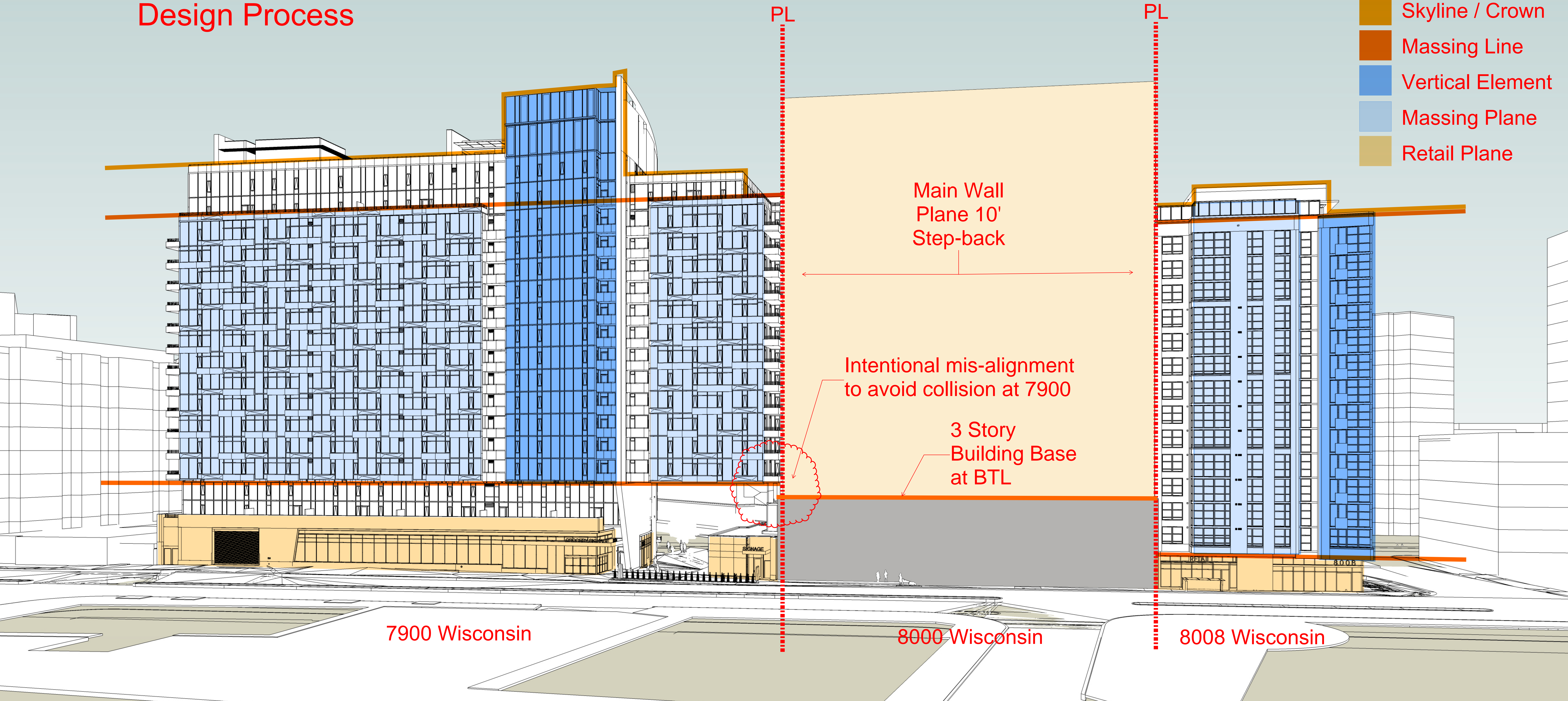

Design Process

- Skyline / Crown
- Massing Line
- Vertical Element
- Massing Plane
- Retail Plane

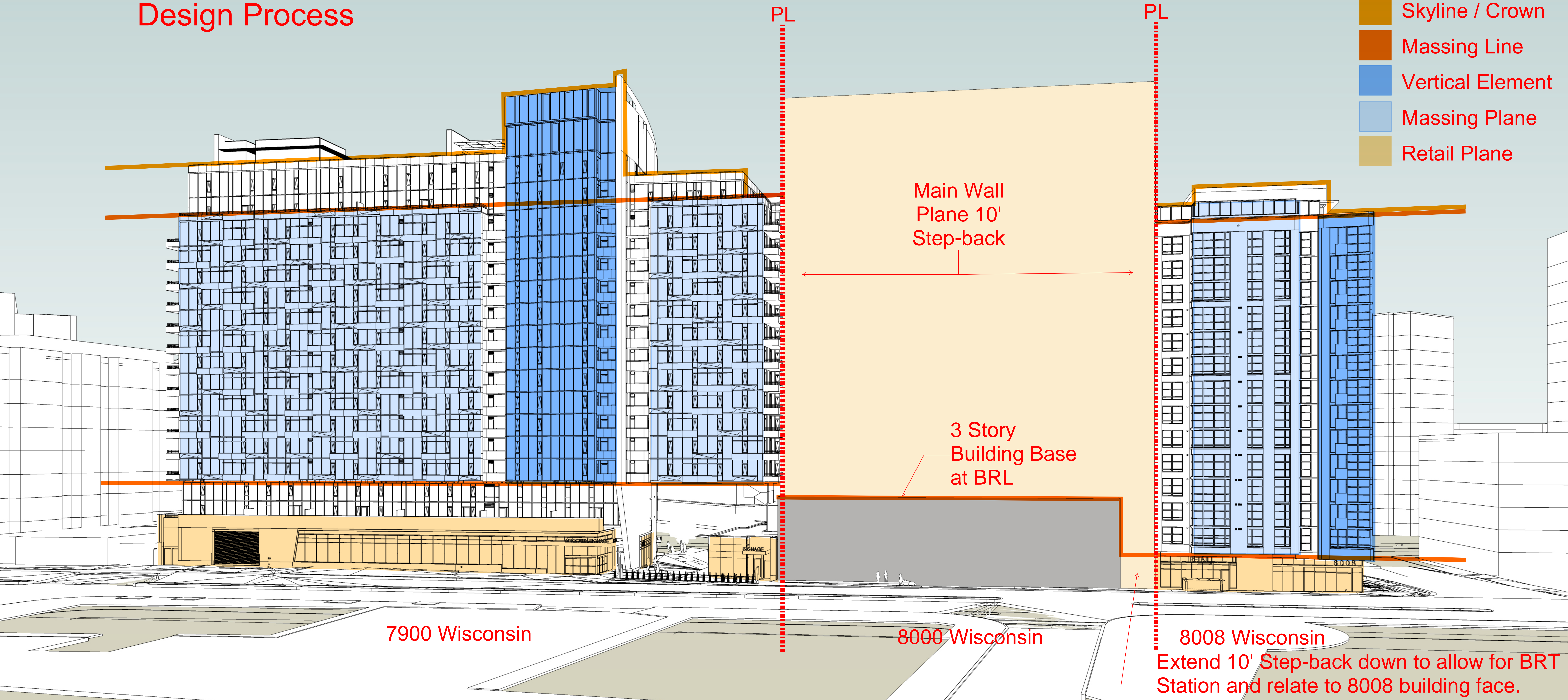

8000 Wisconsin Ave.
Bethesda, MD

Scale: NTS
Date: 2018-03-12

Design Process

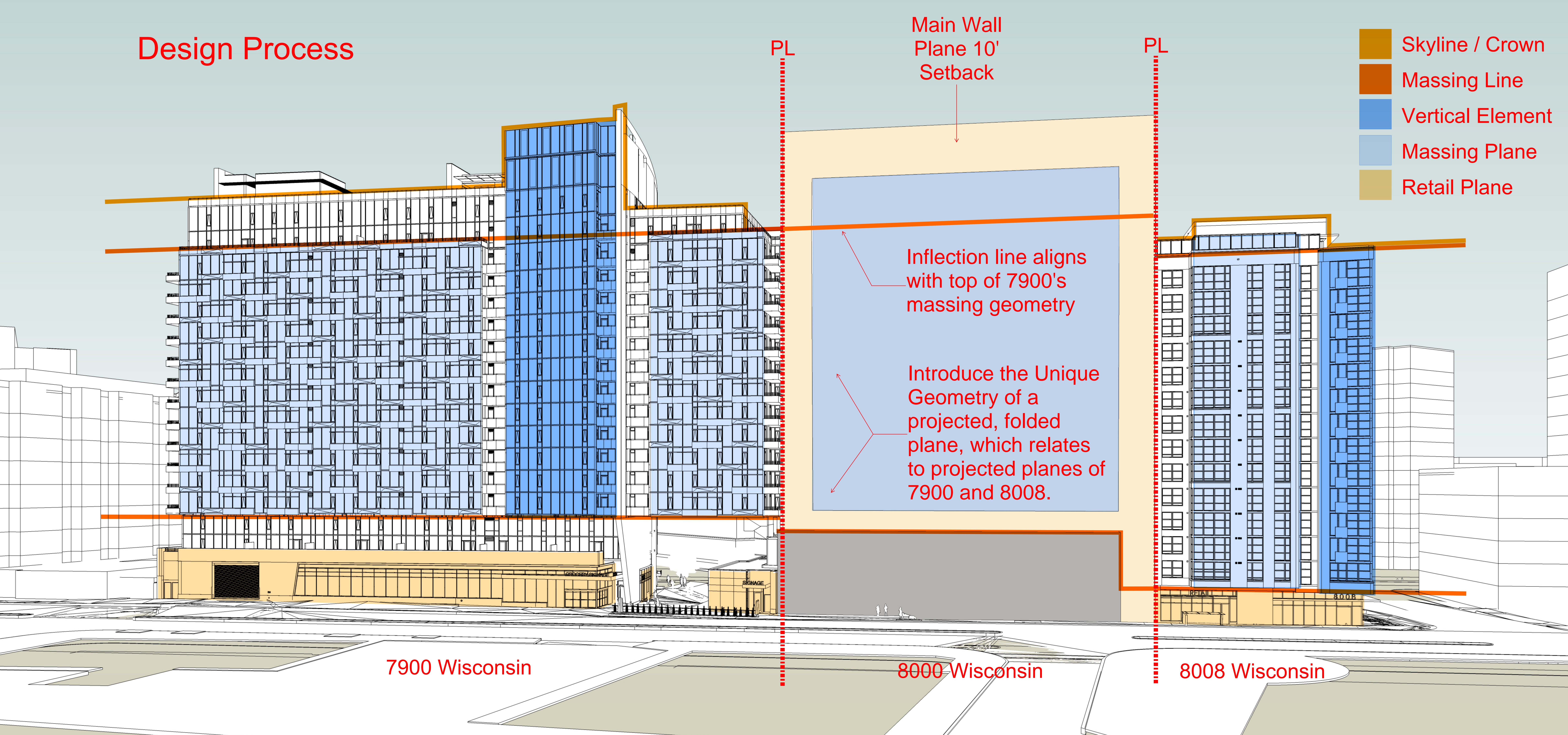

Main Wall
Plane 10'
Setback

PL

PL

- Skyline / Crown
- Massing Line
- Vertical Element
- Massing Plane
- Retail Plane

Inflection line aligns
with top of 7900's
massing geometry

Introduce the Unique
Geometry of a
projected, folded
plane, which relates
to projected planes of
7900 and 8008.

7900 Wisconsin

8000 Wisconsin

8008 Wisconsin

8000 Wisconsin Ave.
Bethesda, MD

Scale: NTS
Date: 2018-03-12

Design Process

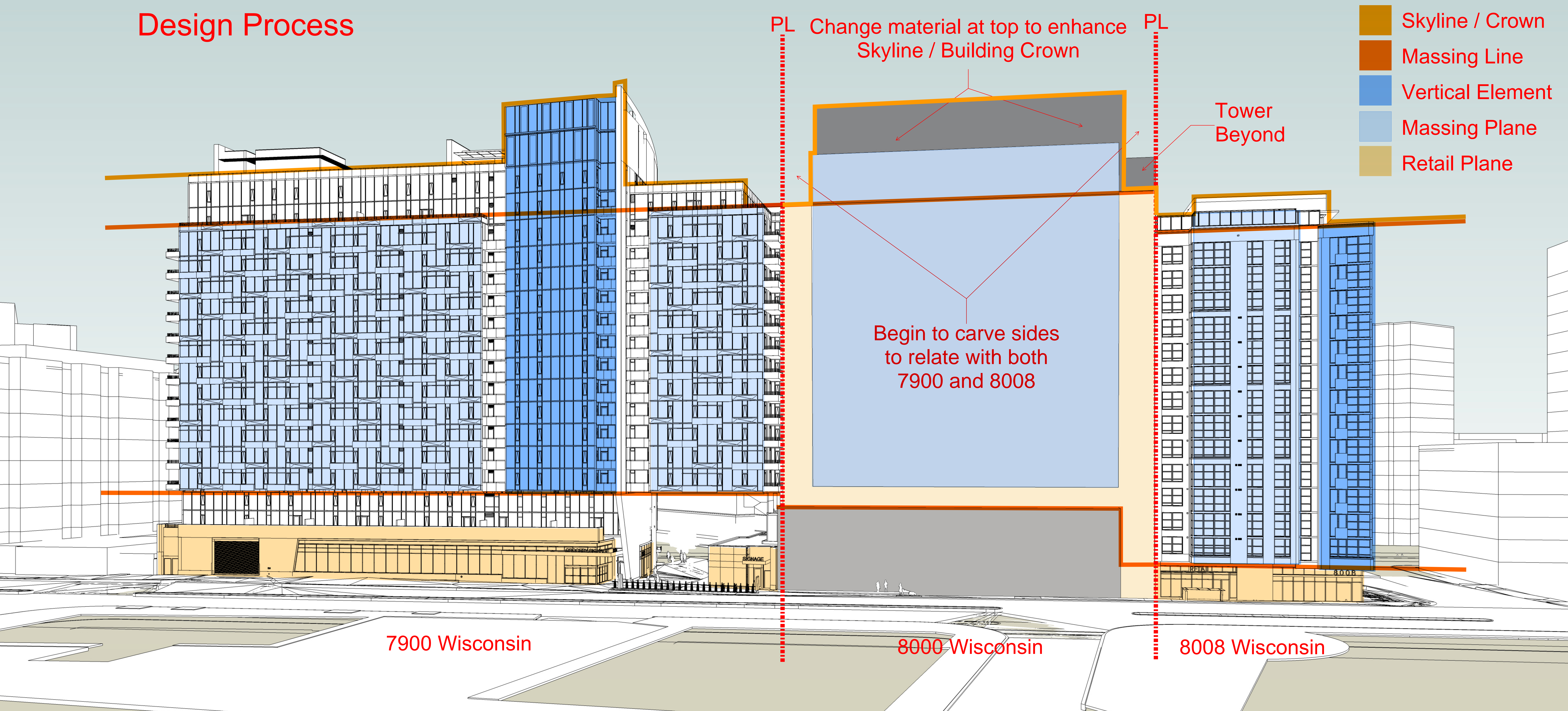

- Skyline / Crown
- Massing Line
- Vertical Element
- Massing Plane
- Retail Plane

PL Change material at top to enhance Skyline / Building Crown

Tower Beyond

Begin to carve sides to relate with both 7900 and 8008

7900 Wisconsin

8000 Wisconsin

8008 Wisconsin

8000 Wisconsin Ave.
Bethesda, MD

Scale: NTS
Date: 2018-03-12

Design Process

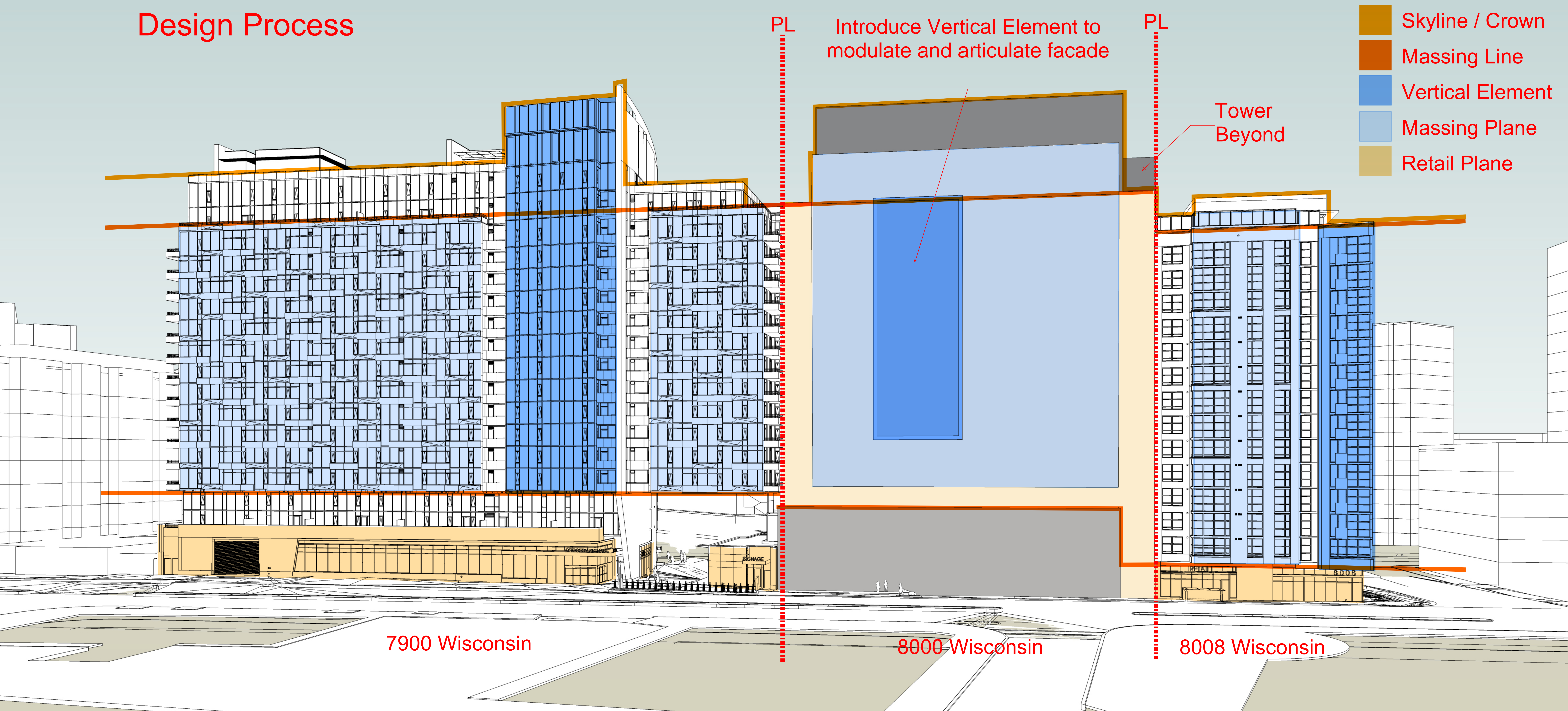

- Skyline / Crown
- Massing Line
- Vertical Element
- Massing Plane
- Retail Plane

Introduce Vertical Element to modulate and articulate facade

Tower Beyond

7900 Wisconsin

8000 Wisconsin

8008 Wisconsin

8000 Wisconsin Ave.
Bethesda, MD

Scale: NTS
Date: 2018-03-12

Design Process

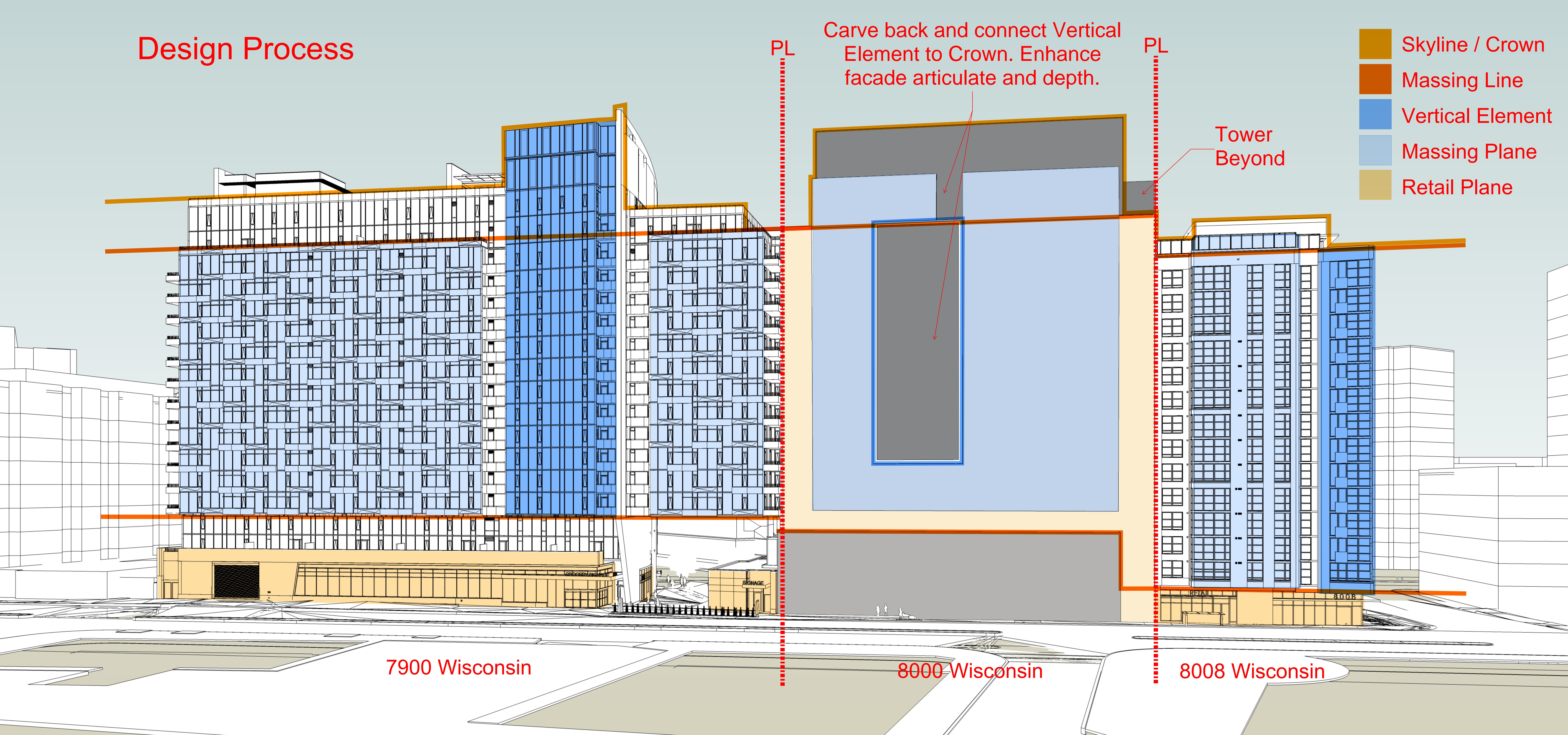

- Skyline / Crown
- Massing Line
- Vertical Element
- Massing Plane
- Retail Plane

Carve back and connect Vertical Element to Crown. Enhance facade articulate and depth.

Tower Beyond

7900 Wisconsin

8000 Wisconsin

8008 Wisconsin

8000 Wisconsin Ave.
Bethesda, MD

Scale: NTS
Date: 2018-03-12

Design Process

Extend Plane up to relate to 7900.

PL

PL

Drop Plane down to relate to 8008.

- Skyline / Crown
- Massing Line
- Vertical Element
- Massing Plane
- Retail Plane

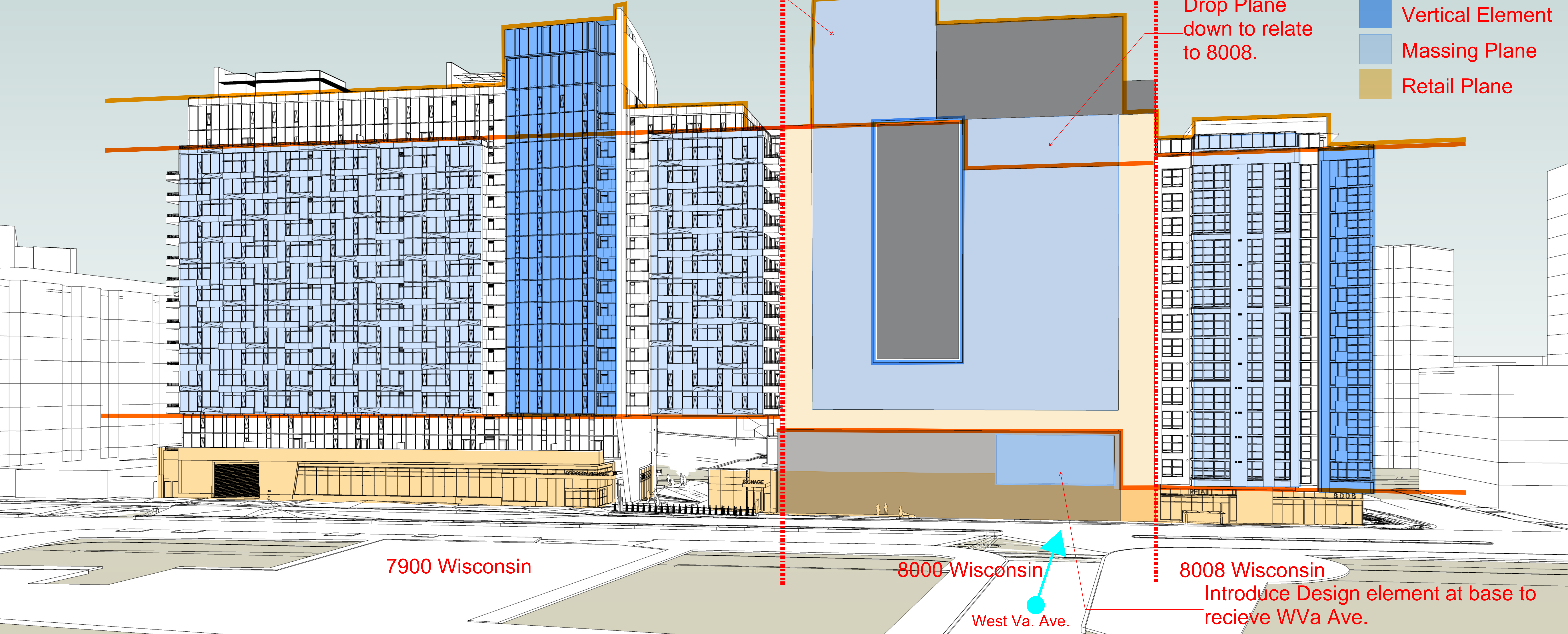

7900 Wisconsin

8000 Wisconsin

West Va. Ave.

8008 Wisconsin

Introduce Design element at base to receive WVa Ave.

8000 Wisconsin Ave.
Bethesda, MD

Scale: NTS
Date: 2018-03-12

View looking up St. Elmo Ave.

Vertical Mass
relates to 7900

Vertical Element telegraphs
through from Wisconsin Ave.

Primary Step-back
tapers 10'-15'

3 Story Base

Retail /
Parking /
Loading Zone

Distance Varies
95' - 120'

